

1 COURTYARD - NORTH ELEVATION
SCALE: 1:100



2 COURTYARD - EAST ELEVATION
SCALE: 1:100



3 COURTYARD - SOUTH ELEVATION
SCALE: 1:100



4 COURTYARD - WEST ELEVATION
SCALE: 1:100

EXTERNAL FINISHES

- BW BLOCKWORK
- CD-01 TIMBER LOOK CLADDING
- CD-02 LIGHT GREY FINISH METAL CLADDING
- CD-03 DARK GREY FINISH METAL CLADDING
- FT-01 ANODISED FINISH FRAME
- GL-01 GLAZED VISION PANEL
- GL-02 SPANDREL PANEL
- HR-01 WIRE BALUSTRADE
- LV-01 PLANT LOUVRE - SCREEN & DOORS
- PA-01 PRE FINISH - LIGHT GREY
- PA-02 PRE FINISH - DARK GREY
- RF-01 PROFILED STEEL ROOF SHEETING - LIGHT GREY
- RF-02 PROFILED STEEL ROOF SHEETING - DARK GREY
- RWT RAINWATER TANK

Note:

All operable window to receive fly screen and opening to be restricted, with anti-ligature consideration

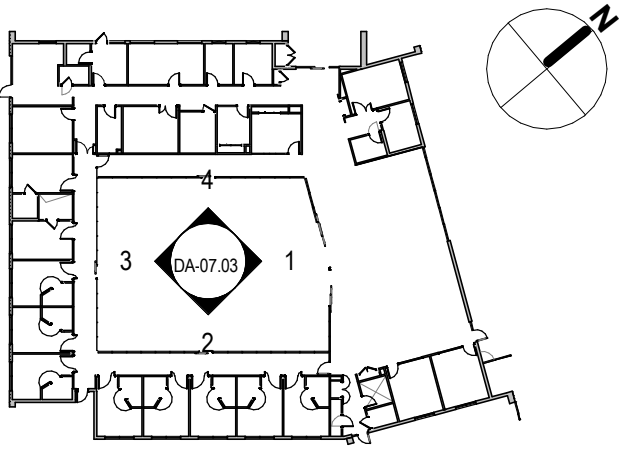

Bushfire Construction Requirements:

Building construction (including external façade systems, external windows & doors, roofs, decks and fences) to be in accordance with the Bushfire Attack Level (BAL) 12.5 and the Australian Standard AS 3959-2018. Refer to bushfire consultant report for details

PROPOSED ELEVATIONS - CATHOLIC CARE COURTYARDS

Watson Youth Health Facilities Development

Project Number 10589

Scale @ A1 Sheet Size As indicated Date 30/06/23

Drawing Number: DA-07.03

