

NOTE:
FLOOR - CEILING
INTERNAL DOORS
CEILING INSULATION
WALL INSULATION
ROOF PITCH

REFER TO FLOOR PLAN & ELEVATIONS
2100mm
R4.0
R2.0
REFER TO ROOF PLAN

SMOKE DETECTORS - NCC Vol. 2 - AS3786-2014 EDITION
REQUIRES INTERCONNECTION OF SMOKE ALARMS WHERE
MORE THAN ONE ALARM IS INSTALLED.

MECHANICAL VENTILATION TO
ENSUITE AND BATHROOMS AS PER NCC Vol 2

BARRIERS AND HANDRAILS AS PER NCC Vol 2

EXTERNAL WATERPROOFING TO COMPLY WITH AS4654-2012

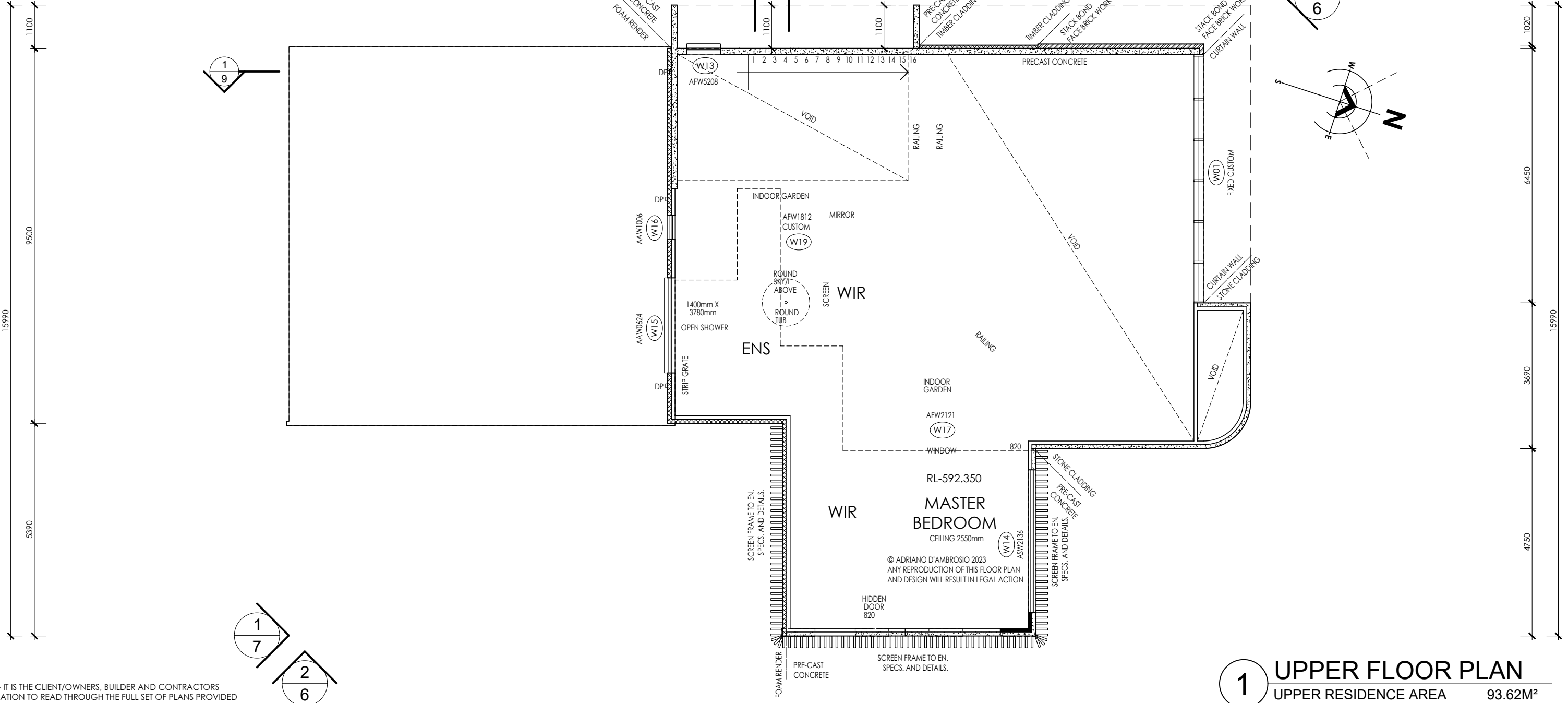

NOTE - IT IS THE CLIENT/OWNERS, BUILDER AND CONTRACTORS
OBLIGATION TO READ THROUGH THE FULL SET OF PLANS PROVIDED
THOROUGHLY PRIOR TO ANY CONSTRUCTION OR WORKS.

**BUILDER/CONTRACTORS TO CONFIRM
DIMENSIONS ONSITE PRIOR TO
COMMENCEMENT OF WORKS.**

NOTE: ALL WORK TO BE DONE IN ACCORDANCE
WITH THE NCC, AUS. STANDARDS, SDHDC ACT AND
LIVABLE HOUSING DESIGN STANDARD 2022

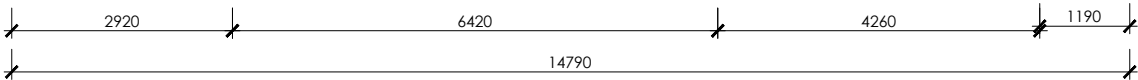

adrianodambrosio
design & drafting

E-mail // adrianodambrosio@outlook.com
Mobile // 0433 237 246



PROPOSED RESIDENCE //

SHEET TITLE // PUBLIC REGISTER UPPER FLOOR PLAN
BLOCK // 16
SUBURB // DEAKIN

SECTION // 21

CLIENT // BRUCIC
SCALE // 1:100 @ A3
DATE // 15 AUG 2023

REVISION // **D**

DWG No // **A21**