

TO ALL KILN VAULTS:

- \* THE INTENT IS FOR THE BRICK KILNS TO BE PRESENTED INTACT WITH A MINIMUM OF REMEDIAL WORKS.
- \* STRUCTURALLY STABILISE VAULTS WHERE REQUIRED TO ENSURE SAFE
- \* FULL HAZARDOUS MATERIALS AUDIT OF ALL SURFACES REMEDIAL WORKS MAY BE REQUIRED TO ENSURE A SAFE USABLE SPACE. DEPENDING ON AUDIT FINDINGS THIS MAY INVOLVE THE REMOVAL OF HAZARDOUS MATERIALS OR THEIR ENCAPSULATION BEHIND A PAINT, FILM OR OTHER BARRIER.
- \* UNDERTAKE A "LIGHT CLEAN" OF BRICK SURFACES TO REMOVE DUST, DIRT, ANY "NON-HERITAGE" GRAFFITI, AND ANY HANGING RESIDUE ON CEILING UNLESS INDICATED DIFFERENTLY.
- \* DISCOLORATION AND TRACES OF THE FIRING PROCESS ARE TO BE LEFT INTACT WHERE IT IS POSSIBLE TO DO SO.

NEW AWNING STRUCTURE AROUND PERIMETER. NEW AWNING IS SIMILAR TO ORIGINAL AWNING IN TERMS OF FORM, SIZE AND COLUMN SPACINGS BUT WITH MODIFIED DESIGN THAT ELIMINATES LOW LEVEL STRUTS, AND INCLUDES SUN SHADING RATHER THAN ROOF SHEET TO BETTER SUIT FUTURE USE.

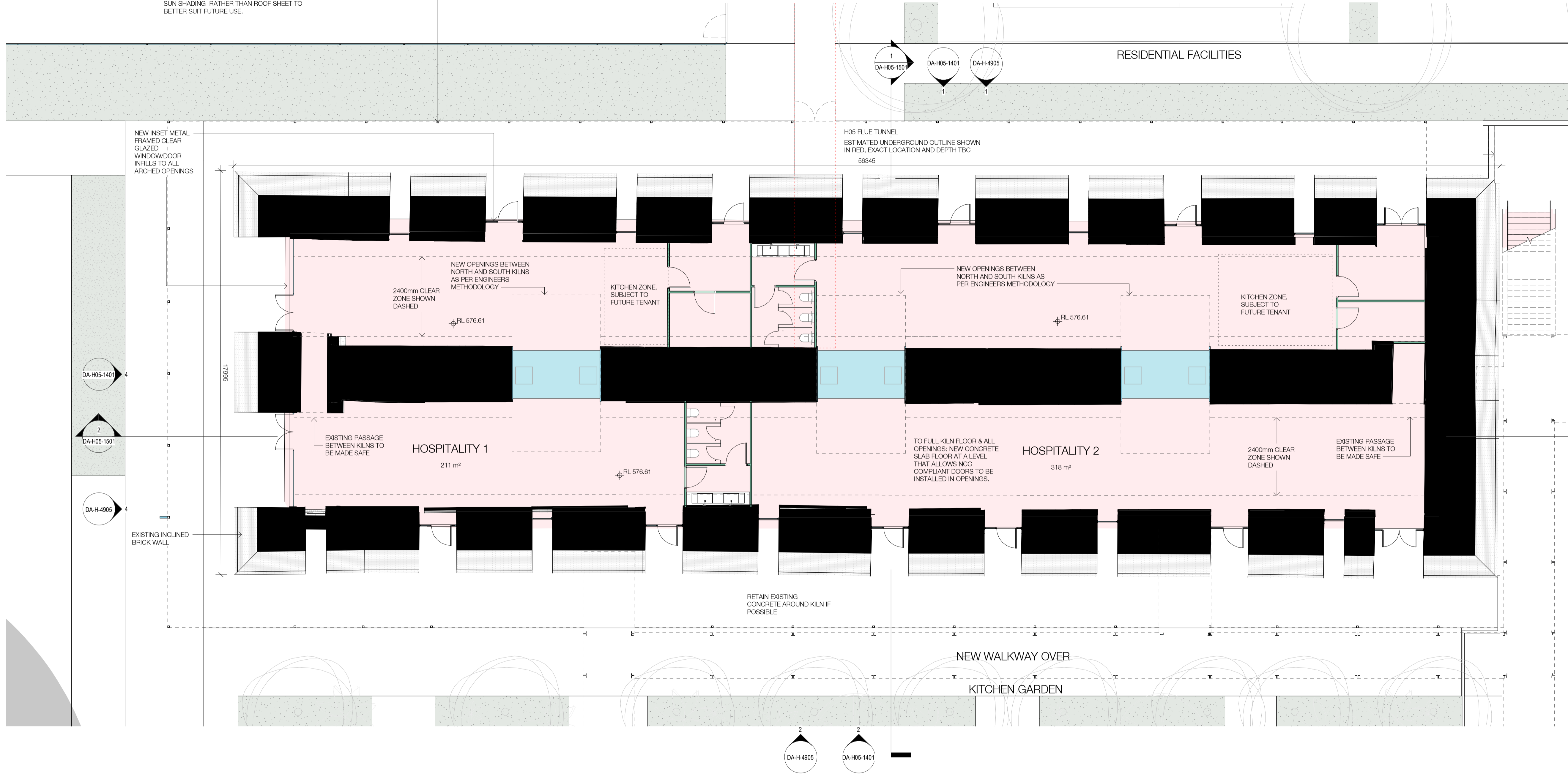

- EXISTING
- PROPOSED - METAL
- PROPOSED - REUSED CORRUGATED
- PROPOSED - GLAZED
- PROPOSED - CONCRETE
- PROPOSED - MASONRY
- PROPOSED - TIMBER
- PROPOSED - LIGHTWEIGHT

Nominated Architects: Adam Haddow-7188 | John Pradel-7004

In accepting and utilising this document the recipient agrees that SJB Architecture (NSW) Pty. Ltd. ACN 081 094 724 T/A SJB Architects, retain all common law, statutory law and other rights including copyright and intellectual property rights. The recipient agrees not to use this document for any purpose other than as intended use; to waive all claims against SJB Architects resulting from unauthorised changes; or to reuse the document on other projects without the prior written consent of SJB Architects. Under no circumstances shall transfer of this document be deemed a sale. SJB Architects makes no warranties of fitness for any purpose. The Builder/Contractor shall verify job dimensions prior to any work commencing. Use figured dimensions only. Do not scale drawings.

**FOR DEVELOPMENT APPLICATION**

| Rev | Date       | Revision        | By | Chk. |
|-----|------------|-----------------|----|------|
| 1   | 15.10.2021 | For Information | DM | EW   |
| 2   | 08.07.2022 | Draft DA Issue  | DM | EW   |
| 3   | 15.08.2022 | Issue for DA    | DM | EW   |
| 4   | 28.04.2023 | For Information | DM | EW   |
| 5   | 19.07.2023 | For Approval    | DM | EW   |

Client  
**DOMA**

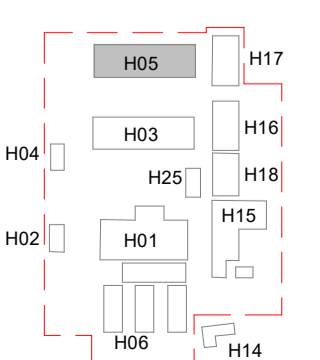

Project  
**BRICKWORKS HERITAGE CORE - Yarralumla, ACT 2600**

Building  
**H05 - HARDY PATENT KILN 2**

Drawing Name  
**Floor Plan - Ground**

| Date       | Scale           | Sheet Size |
|------------|-----------------|------------|
| 19.07.2023 | 1 : 100         | @ A1       |
| Drawn      | Chk.            |            |
| DM         | EW              |            |
| Job No.    | Drawing No.     | Revision   |
| 5479       | DA-H05-1001 / 5 |            |

SJB Architects

Level 2  
490 Crown Street  
Surry Hills NSW  
2010 Australia  
T 61 2 9380 9911  
F 61 2 9380 9922  
www.sjb.com.au

