

H01 - STAFFORDSHIRE KILN

DA-H-4903

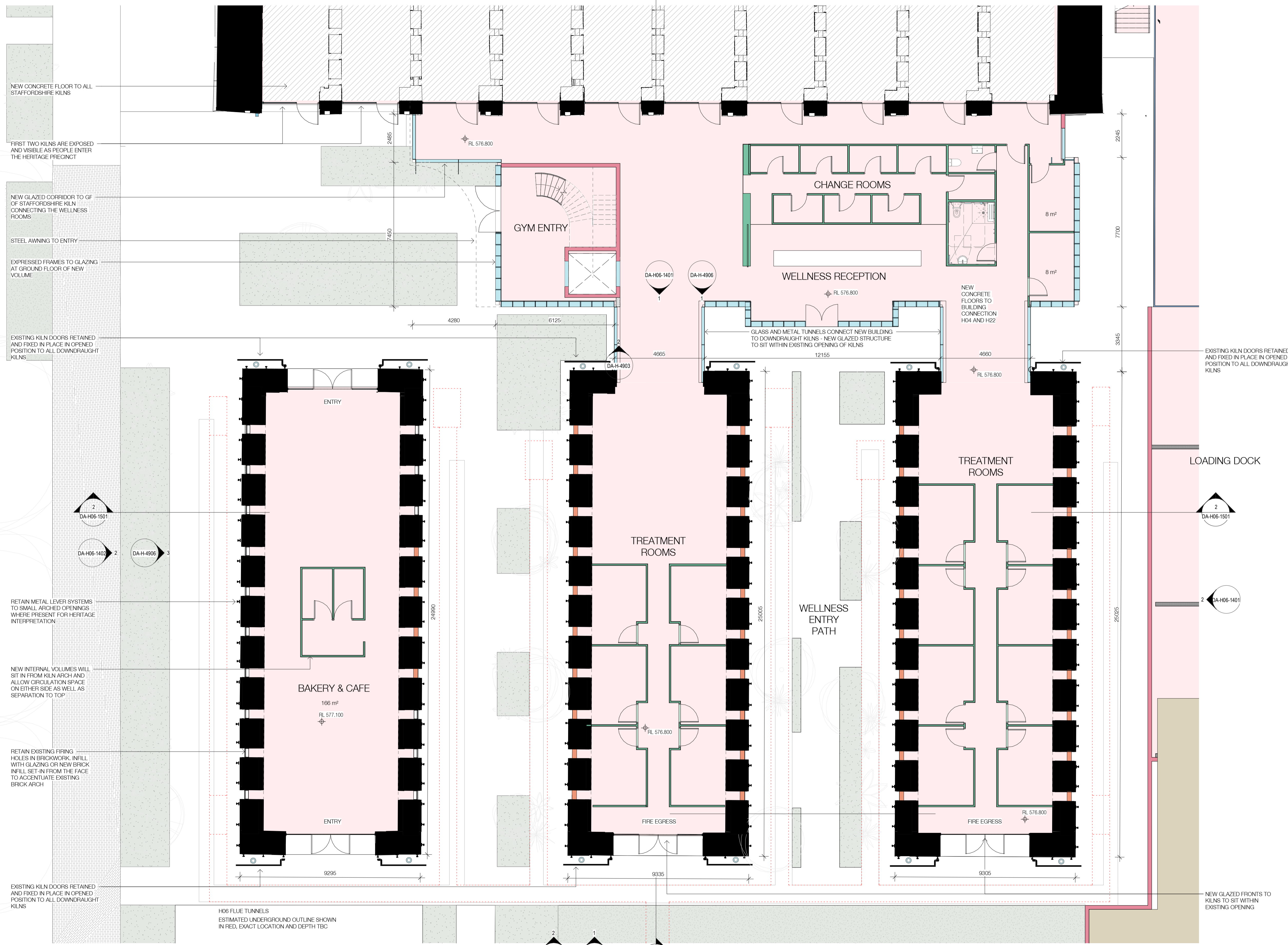

- TO ALL KILN VAULTS:
- * THE INTENT IS FOR THE BRICK KILNS TO BE PRESENTED INTACT WITH A MINIMUM OF REMEDIAL WORKS.
 - * STRUCTURALLY STABILISE VAULTS WHERE REQUIRED TO ENSURE SAFE
 - * FULL HAZARDOUS MATERIALS AUDIT OF ALL SURFACES REMEDIAL WORKS MAY BE REQUIRED TO ENSURE A SAFE USABLE SPACE. DEPENDING ON AUDIT FINDINGS THIS MAY INVOLVE THE REMOVAL OF HAZARDOUS MATERIALS OR THEIR ENCAPSULATION BEHIND A PAINT, FILM OR OTHER BARRIER.
 - * UNDERTAKE A 'LIGHT CLEAN' OF BRICK SURFACES TO REMOVE DUST, DIRT, ANY 'NON-HERITAGE' GRAFFITI, AND ANY HANGING RESIDUE ON CEILING UNLESS INDICATED DIFFERENTLY.
 - * DISCOLORATION AND TRACES OF THE FIRING PROCESS ARE TO BE LEFT INTACT WHERE IT IS POSSIBLE TO DO SO.

NEW CONCRETE FLOOR TO ALL STAFFORDSHIRE KILNS

FIRST TWO KILNS ARE EXPOSED AND VISIBLE AS PEOPLE ENTER THE HERITAGE PRECINCT

NEW GLAZED CORRIDOR TO GF OF STAFFORDSHIRE KILN CONNECTING THE WELLNESS ROOMS

STEEL AWNING TO ENTRY

EXPRESSED FRAMES TO GLAZING AT GROUND FLOOR OF NEW VOLUME

EXISTING KILN DOORS RETAINED AND FIXED IN PLACE IN OPENED POSITION TO ALL DOWNDRAUGHT KILNS

RETAIN METAL LEVER SYSTEMS TO SMALL ARCHED OPENINGS WHERE PRESENT FOR HERITAGE INTERPRETATION

NEW INTERNAL VOLUMES WILL SIT IN FROM KILN ARCH AND ALLOW CIRCULATION SPACE ON EITHER SIDE AS WELL AS SEPARATION TO TOP

RETAIN EXISTING FIRING HOLES IN BRICKWORK. INFILL WITH GLAZING OR NEW BRICK INFILL SET IN FROM THE FACE TO ACCENTUATE EXISTING BRICK ARCH

EXISTING KILN DOORS RETAINED AND FIXED IN PLACE IN OPENED POSITION TO ALL DOWNDRAUGHT KILNS

H06 FLUE TUNNELS ESTIMATED UNDERGROUND OUTLINE SHOWN IN RED, EXACT LOCATION AND DEPTH TBC

LOADING DOCK

- EXISTING
- PROPOSED - METAL
- PROPOSED - REUSED CORRUGATED
- PROPOSED - GLAZED
- PROPOSED - CONCRETE
- PROPOSED - MASONRY
- PROPOSED - TIMBER
- PROPOSED - LIGHTWEIGHT

Nominated Architects: Adam Haddow-7188 | John Pradel-7004

In accepting and utilizing this document the recipient agrees that SJB Architecture (NSW) Pty. Ltd. ACN 081 094 724 T/A SJB Architects, retain all common law, statutory law and other rights including copyright and intellectual property rights. The recipient agrees not to use this document for any purpose other than as intended use; to waive all claims against SJB Architects resulting from unauthorised changes; or to reuse the document on other projects without the prior written consent of SJB Architects. Under no circumstances shall transfer of this document be deemed a sale. SJB Architects makes no warranties of fitness for any purpose. The Builder/Contractor shall verify job dimensions prior to any work commencing. Use figured dimensions only. Do not scale drawings.

FOR DEVELOPMENT APPLICATION

Rev	Date	Revision	By	Chk.
1	15.10.2021	For Information	DM	EW
2	08.07.2022	Draft DA Issue	DM	EW
3	15.08.2022	Issue for DA	DM	EW
4	28.04.2023	For Information	DM	EW
5	19.07.2023	For Approval	DM	EW

Client
DOMA

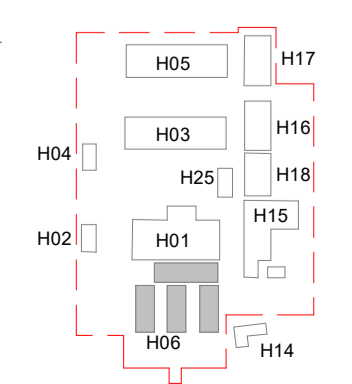

Project
BRICKWORKS HERITAGE CORE - Yarralumla, ACT 2600

Building
H06 - DOWNDRAUGHT KILNS

Drawing Name
Floor Plan - Ground

Date
19.07.2023

Scale
1 : 100

Sheet Size
@ A1

Drawn
DM

Chk.
EW

Job No.
5479

Drawing No.
DA-H06-1001 / 5

Revision

SJB Architects
Level 2
490 Crown Street
Surry Hills NSW
2010 Australia
T 61 2 9380 9911
F 61 2 9380 9922
www.sjb.com.au

