

**1 DA-H25 - Demolition Plan - Ground**  
1 : 100@A1

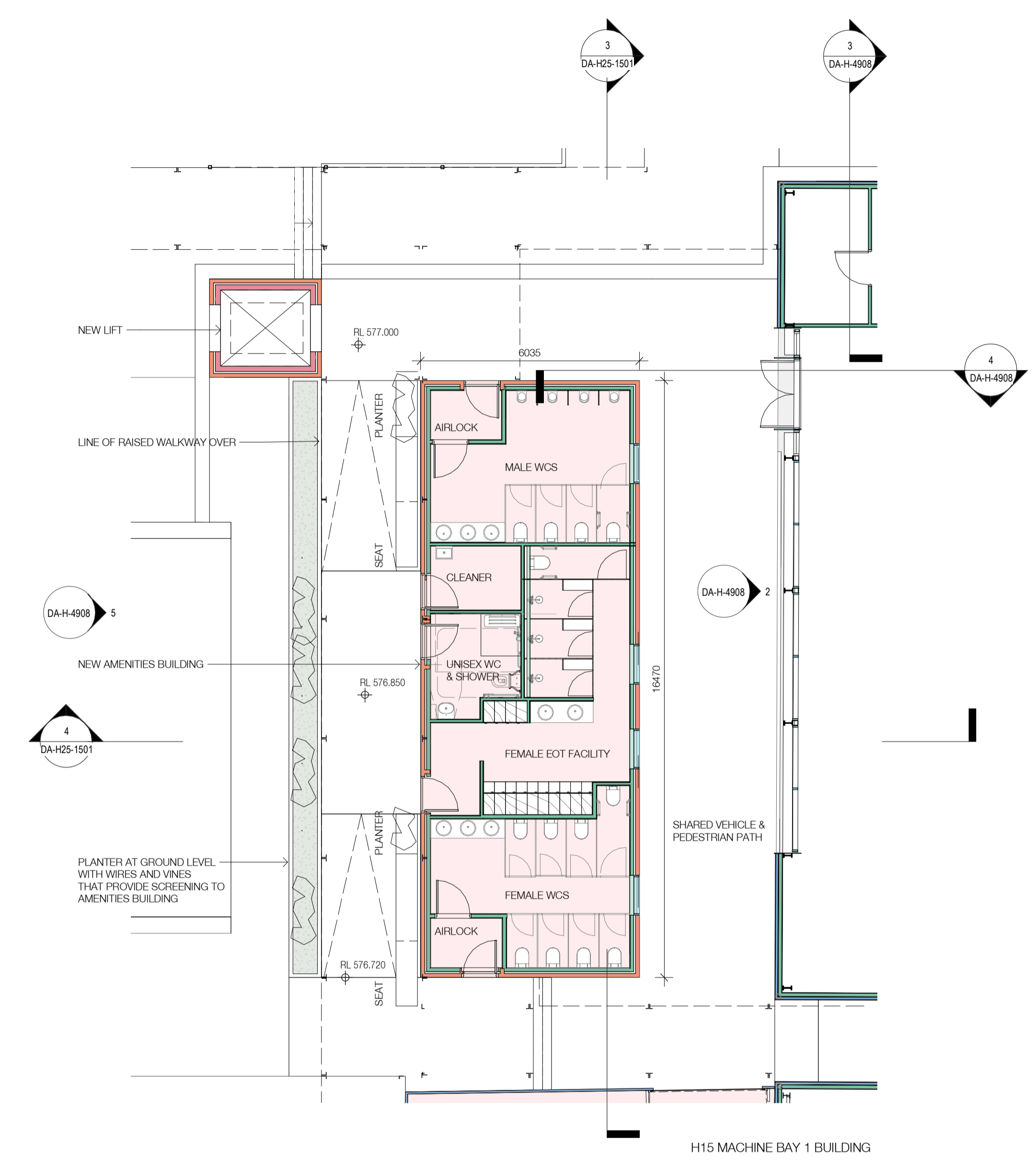

**2 DA-H25 - Ground**  
1 : 100@A1

- EXISTING
- PROPOSED - METAL
- PROPOSED - REUSED CORRUGATED
- PROPOSED - GLAZED
- PROPOSED - CONCRETE
- PROPOSED - MASONRY
- PROPOSED - TIMBER
- PROPOSED - LIGHTWEIGHT
- EXISTING
- ELEMENTS DEMOLISHED
- ELEMENTS REMOVED BUT STORED ON SITE FOR REUSE

Nominated Architects: Adam Haddow-7188 | John Pradel-7004

In accepting and utilising this document the recipient agrees that SJB Architecture (NSW) Pty. Ltd. ACN 081 094 724 T/A SJB Architects, retain all common law, statutory law and other rights including copyright and intellectual property rights. The recipient agrees not to use this document for any purpose other than as intended use; to waive all claims against SJB Architects resulting from unauthorised changes; or to reuse the document on other projects without the prior written consent of SJB Architects. Under no circumstances shall transfer of this document be deemed a sale. SJB Architects makes no warranties of fitness for any purpose. The Builder/Contractor shall verify job dimensions prior to any work commencing. Use figured dimensions only. Do not scale drawings.

Rev	Date	Revision	By	Chk.
1	15.10.2021	For Information	DM	EW
2	08.07.2022	Draft DA Issue	DM	EW
3	15.08.2022	Issue for DA	DM	EW
4	19.07.2023	For Approval	DM	EW

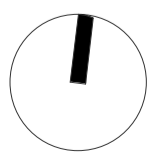

Client  
**DOMA**

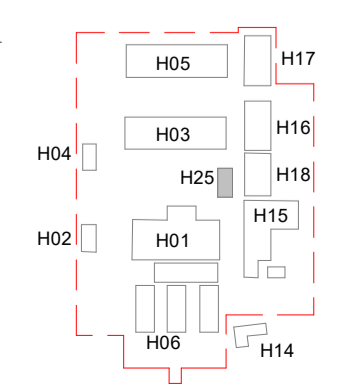

Project  
**BRICKWORKS HERITAGE CORE - Yarralumla, ACT 2600**

Building  
**H25 - AMENITIES**

Drawing Name  
**Floor Plan - Ground**

Date	Scale	Sheet Size	SJB Architects
19.07.2023	1 : 100	@ A1	
Drawn	Chk.		
DM	EW		
Job No.	Drawing No.	Revision	
5479	DA-H25-1001 / 4		

Level 2  
490 Crown Street  
Surry Hills NSW  
2010 Australia  
T 61 2 9380 9911  
F 61 2 9380 9922  
www.sjb.com.au



**FOR APPROVAL**