

TO ALL KILN VAULTS:

- \* THE INTENT IS FOR THE BRICK KILNS TO BE PRESENTED INTACT WITH A MINIMUM OF REMEDIAL WORKS.
- \* STRUCTURALLY STABILISE VAULTS WHERE REQUIRED TO ENSURE SAFE
- \* FULL HAZARDOUS MATERIALS AUDIT OF ALL SURFACES REMEDIAL WORKS MAY BE REQUIRED TO ENSURE A SAFE USABLE SPACE. DEPENDING ON AUDIT FINDINGS THIS MAY INVOLVE THE REMOVAL OF HAZARDOUS MATERIALS OR THEIR ENCAPSULATION BEHIND A PAINT, FILM OR OTHER BARRIER.
- \* UNDERTAKE A "LIGHT CLEAN" OF BRICK SURFACES TO REMOVE DUST, DIRT, ANY "NON-HERITAGE" GRAFFITI, AND ANY HANGING RESIDUE ON CEILING UNLESS INDICATED DIFFERENTLY.
- \* DISCOLORATION AND TRACES OF THE FIRING PROCESS ARE TO BE LEFT INTACT WHERE IT IS POSSIBLE TO DO SO.

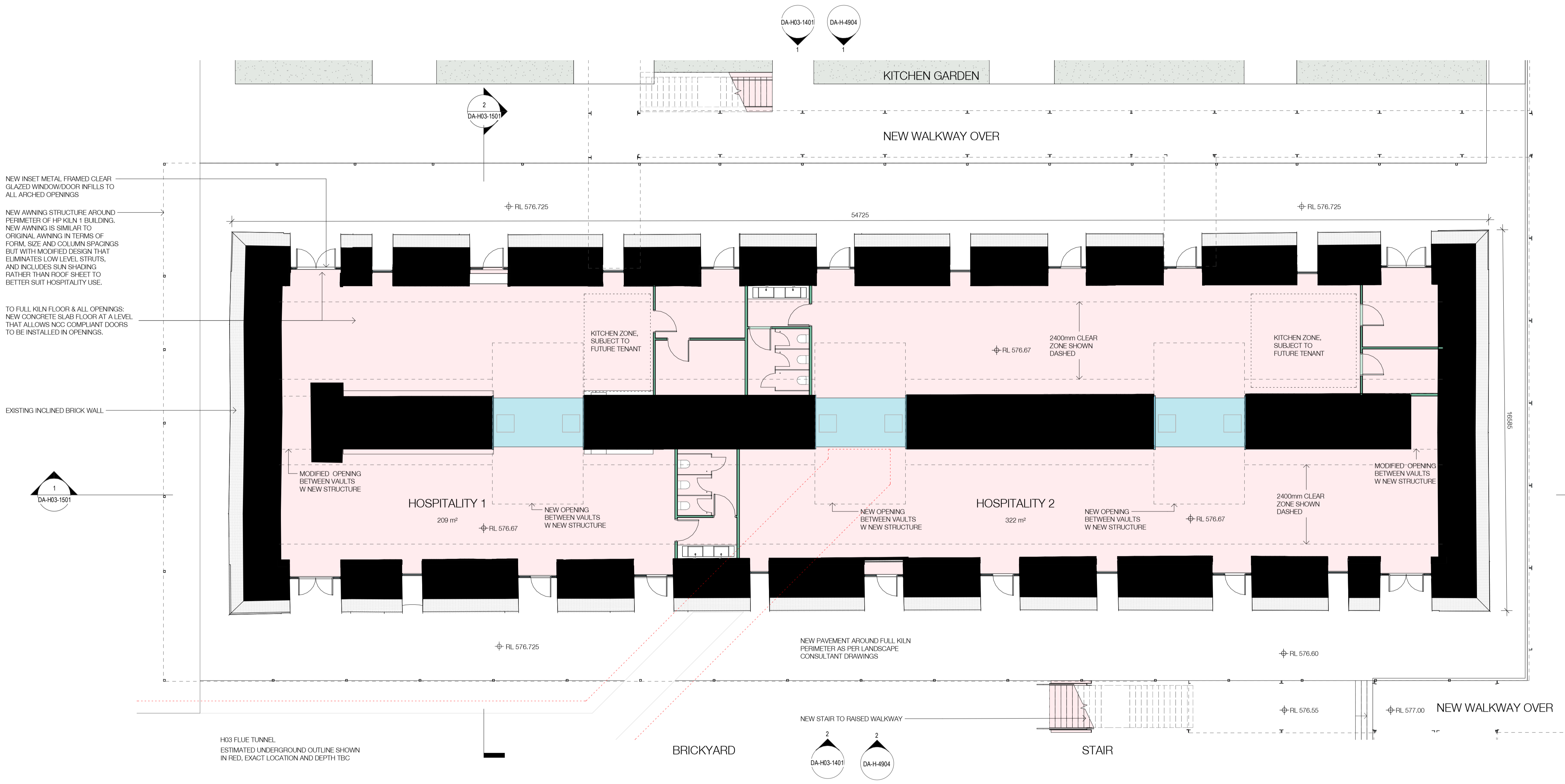

NEW INSET METAL FRAMED CLEAR GLAZED WINDOW/DOOR INFILLS TO ALL ARCHED OPENINGS

NEW AWNING STRUCTURE AROUND PERIMETER OF HP KILN 1 BUILDING. NEW AWNING IS SIMILAR TO ORIGINAL AWNING IN TERMS OF FORM, SIZE AND COLUMN SPACINGS BUT WITH MODIFIED DESIGN THAT ELIMINATES LOW LEVEL STRUTS, AND INCLUDES SUN SHADING RATHER THAN ROOF SHEET TO BETTER SUIT HOSPITALITY USE.

TO FULL KILN FLOOR & ALL OPENINGS: NEW CONCRETE SLAB FLOOR AT A LEVEL THAT ALLOWS NCC COMPLIANT DOORS TO BE INSTALLED IN OPENINGS.

EXISTING INCLINED BRICK WALL

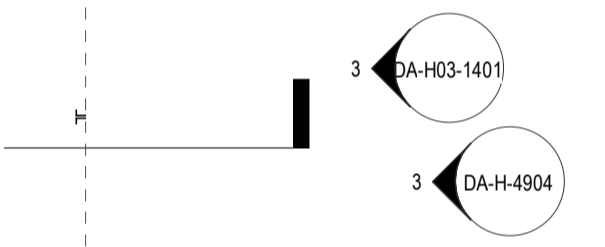
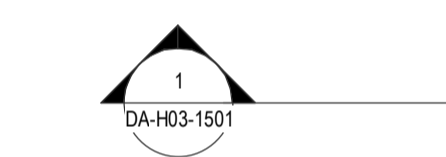

- EXISTING
- PROPOSED - METAL
- PROPOSED - REUSED CORRUGATED
- PROPOSED - GLAZED
- PROPOSED - CONCRETE
- PROPOSED - MASONRY
- PROPOSED - TIMBER
- PROPOSED - LIGHTWEIGHT

Nominated Architects: Adam Haddow-7188 | John Pradel-7004

In accepting and utilizing this document the recipient agrees that SJB Architecture (NSW) Pty. Ltd. ACN 081 094 724 T/A SJB Architects, retain all common law, statutory law and other rights including copyright and intellectual property rights. The recipient agrees not to use this document for any purpose other than as intended; to waive all claims against SJB Architects resulting from unauthorised changes; or to reuse the document on other projects without the prior written consent of SJB Architects. Under no circumstances shall transfer of this document be deemed a sale. SJB Architects makes no warranties of fitness for any purpose. The Builder/Contractor shall verify job dimensions prior to any work commencing. Use figured dimensions only. Do not scale drawings.

**FOR DEVELOPMENT APPLICATION**

Rev	Date	Revision	By	Chk.
1	15.10.2021	For Information	DM	EW
2	08.07.2022	Draft DA Issue	DM	EW
3	15.08.2022	Issue for DA	DM	EW
4	28.04.2023	For Information	DM	EW
5	19.07.2023	For Approval	DM	EW

Client  
**DOMA**

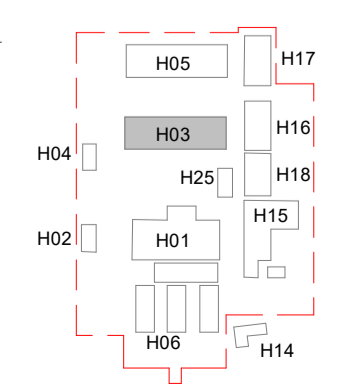

Project  
**BRICKWORKS HERITAGE CORE - Yarralumla, ACT 2600**

Building  
**H03 - HARDY PATENT KILN 1**

Drawing Name  
**Floor Plan - Ground**

Date	Scale	Sheet Size	SJB Architects
19.07.2023	1 : 100	<b>@ A1</b>	
Drawn	Chk.		
DM	EW		
Job No.	Drawing No.	Revision	
5479	DA-H03-1001 / 5		

Level 2  
490 Crown Street  
Surry Hills NSW  
2010 Australia  
T 61 2 9380 9911  
F 61 2 9380 9922  
www.sjb.com.au

