

- GENERAL:**
- DRAWING TO BE READ IN CONJUNCTION WITH C.51, C.52 & C.53
 - REFER TO DRAWING C.1025 FOR SWEEPED PATH ANALYSIS OF THE EXISTING DRIVEWAY.
 - ALL WORKS TO BE IN ACCORDANCE WITH THE TCCS MUNICIPAL INFRASTRUCTURE STANDARDS.

- PROPOSED ARRANGEMENT:**
- REFER TO DRAWING C.51 FOR VERGE WORKS GENERAL ARRANGEMENT.
 - REFER TO DRAWING C.52 FOR DRIVEWAY DETAILS.
 - REFER TO DRAWING C.53 FOR PROPOSED BUS STOP RELOCATION DETAIL.

- SERVICES:**
- REFER TO DRAWING C.01 FOR INFORMATION REGARDING EXISTING SERVICES.
 - REFER TO DRAWING C.10 FOR INFORMATION REGARDING PROPOSED SERVICES.

- PROPOSED DRIVEWAYS:**
- WASTE/RECYCLING COLLECTION VEHICLES ARE PROPOSED TO ACCESS SITE VIA THE DRIVEWAYS ON UNWIN STREET AND HEYSEN STREET (WEST).
 - SERVICE DRIVEWAY GRADING TO BE IN ACCORDANCE WITH VEHICULAR AND PEDESTRIAN ACCESSIBILITY STANDARDS AND THE 2016 ACT WASTE CODE. REFER TO DRAWING C.1051 FOR GRADING DETAILS.

- PAVEMENT:**
- ALL WORKS TO BE IN ACCORDANCE WITH TCCS MUNICIPAL INFRASTRUCTURE STANDARDS UNLESS NOTED OTHERWISE.
 - TRIMMER BARS TO BE D12 REINFORCEMENT, MINIMUM 600mm IN LENGTH, 200mm APART, TIED TO UNDERSIDE OF REINFORCEMENT LAYER.
 - RE-ENTRANT BARS TO BE MINIMUM 900mm IN LENGTH TIED TO THE UNDERSIDE OF THE REINFORCEMENT LAYER.
 - ALL BASECOURSE MATERIAL TO COMPLY WITH TCCS MUNICIPAL INFRASTRUCTURE STANDARDS AND COMPACTED TO 95% MMDD.
 - ALL CONCRETE PAVEMENTS TO BE BROOM FINISHED U.N.O. CONCRETE AT GRADES GREATER THAN 10% TO BE HEAVILY BROOM FINISHED.
 - ANY PROPOSED ADJUSTMENT TO JOINTING LAYOUT TO BE SUBMITTED TO AND APPROVED BY ENGINEER PRIOR TO CONSTRUCTION.

- PAVEMENTS NEAR EXISTING TREES:**
- OUTER EXTENT OF PROPOSED PAVEMENTS TO BE HYDROEXCAVATED AT A REDUCED PRESSURE FOR FULL DEPTH OF PAVEMENT TO IDENTIFY ANY MAJOR TREE ROOTS CROSSING THE EXTENTS.
 - NO TREE ROOTS GREATER THAN 35mm IN DIAMETER ARE TO BE CUT.
 - TREE ROOTS LESS THAN 35mm THAT ARE CUT ARE TO BE WRAPPED IN HESSIAN AND KEPT MOIST PRIOR TO BACKFILLING.

- KERBING:**
- LANDSCAPING TO MATCH LEVELS OF TOP OF KERB ALONG INTERFACE.

SCHEDULE OF WITNESS AND HOLD POINTS - PAVEMENT
HOLD POINTS TO BE ADDRESSED BY CONTRACTOR AND RELEASED BY ENGINEER PRIOR TO CONTINUATION OF WORK.

WITNESS POINTS TO BE ADDRESSED AND WRITTEN RELEASE ISSUED BY ENGINEER PRIOR TO CONTINUATION OF WORKS.

- | | | |
|------|----|---|
| 2.01 | HP | INTEGRITY OF MATERIAL DELIVERY DOCKETS OF MATERIAL PROPOSED TO BE USED AS BASECOURSE, REINFORCEMENT AND CONCRETE TO BE PROVIDED TO ENGINEER FOR VERIFICATION. |
| 2.02 | WP | SUBGRADE CONDITION CONTRACTOR TO PREPARE SUBGRADE FOR INSPECTION. ENGINEER TO PROVIDE WRITTEN APPROVAL OF COMPACTED SUBGRADE, AS INSPECTED, BEFORE CONTRACTOR IS TO CONTINUE CONSTRUCTING PAVEMENT. |
| 2.03 | WP | BASECOURSE CONDITION CONTRACTOR TO PREPARE BASECOURSE FOR INSPECTION. ENGINEER TO PROVIDE WRITTEN APPROVAL OF COMPACTED SUBGRADE, AS INSPECTED, BEFORE CONTRACTOR IS TO CONTINUE CONSTRUCTING PAVEMENT. |
| 2.04 | WP | FORMWORK INSPECTION CONTRACTOR TO INSTALL FORMWORK ASSOCIATED WITH ON-SITE PAVEMENTS. ENGINEER TO PROVIDE WRITTEN APPROVAL OF FORMWORK, AS INSPECTED, BEFORE CONTRACTOR POURS CONCRETE. |

LEGEND

SERVICE	EXISTING	PROPOSED
WATER MAIN	eW	W
SEWER MAIN	eS	S
SEWER RISING MAIN	eSRM	
STORMWATER MAIN	eSW	SW
GAS MAIN	eG	
ELECTRICITY	eE	
ELECTRICITY UG/HV	eUG/HV	
ELECTRICITY UG/LV	eUG/LV	
STREETLIGHT MAIN	eSL	
OPTUS MAIN	eOP	
TELSTRA MAIN	eT	
TRANSCAT MAIN	eTA	
COMMUNICATIONS	eC	
ABANDONED SERVICE	-x-x- W-x-x-	-x-x- W-x-x-
BLOCK BOUNDARY	- - - - -	
TREE TO BE REMOVED		⊙

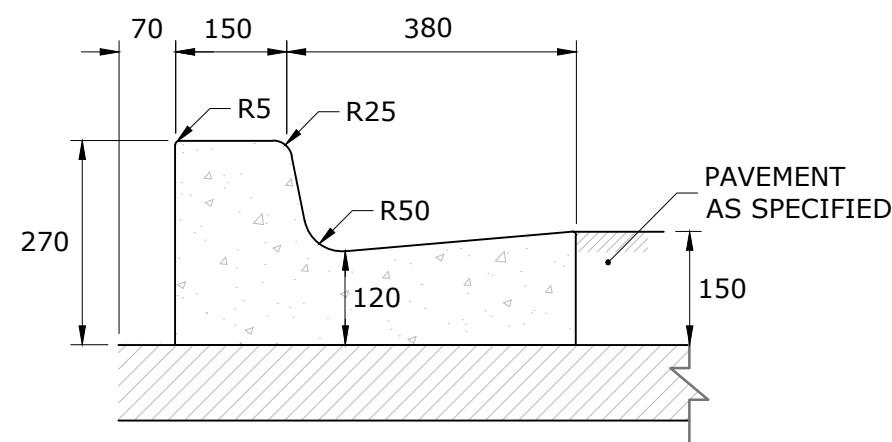

- N25 CONCRETE KERB & GUTTER
- 100mm DGB20 BASE
- EXPANSION JOINTS @ 12m CENTERS
- WEAKENED PLANE JOINTS @ 3m CENTERS
- STEEL FLOAT FINISH APPLIED TO KERB & GUTTER
- ALL JOINTS IN KERBS SHALL BE IN ACCORDANCE WITH SECTION 6.09.1 OF "STANDARD SPECIFICATION FOR URBAN INFRASTRUCTURE WORKS" EDITION 1, REVISION 0/SEPT 2002
- ALL DIMENSIONS SHOWN ON DETAIL ARE IN mm

KERB & GUTTER (K&G)
SCALE 1:10 @ A1

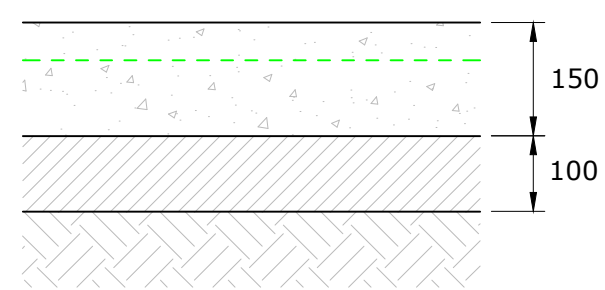

- ASSUMED CBR > 3%
- 150mm N25 CONCRETE
- SL82 WITH 50mm TOP COVER
- 100mm DGB20 COMPACTED TO 98%MMDD
- SUBGRADE COMPACTED TO 95%MMDD
- JOINTING AS PER PLAN

HEAVY DUTY RIGID PAVEMENT
SCALE 1:10 @ A1

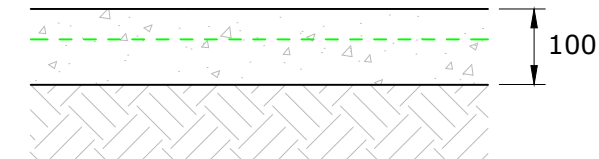

- ASSUMED CBR > 3%
- 100mm N25 CONCRETE
- SL82 WITH 40mm TOP COVER
- SUBGRADE COMPACTED TO 98%MMDD
- JOINTING AS PER PLAN

LIGHT DUTY RIGID PAVEMENT
SCALE 1:10 @ A1

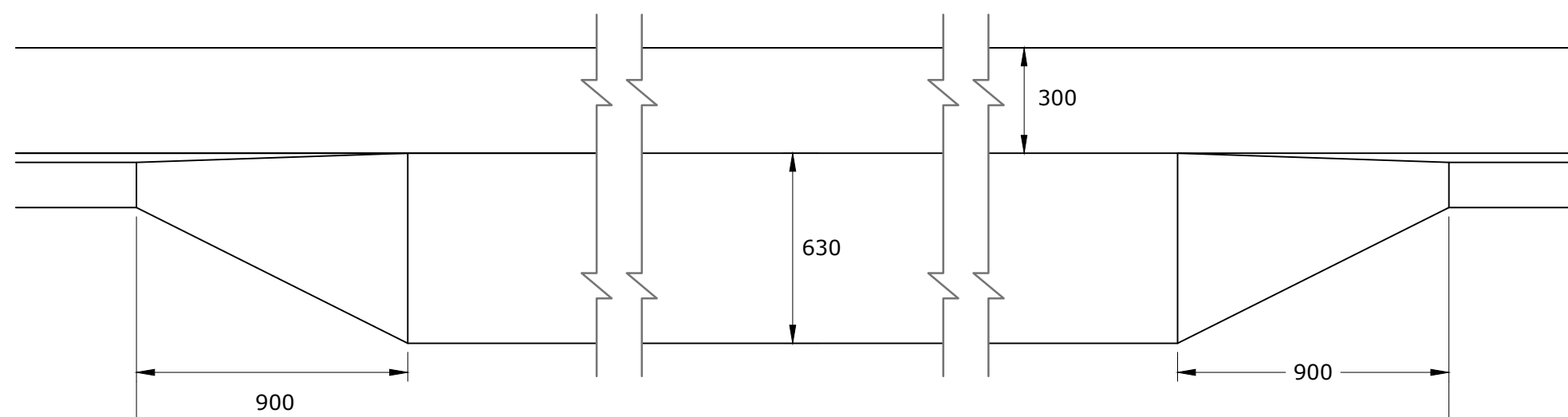

REINFORCED VEHICLE CROSSING (RVC) - PLAN
NTS

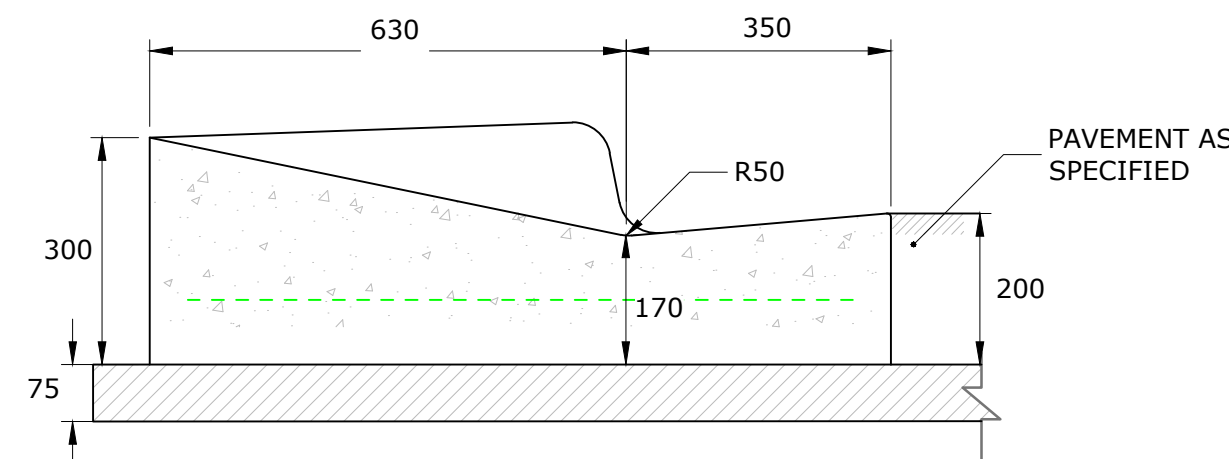

- N32 CONCRETE VEHICLE CROSSING
- 1 LAYER SL82 REINFORCEMENT WITH 50mm TOP COVER
- MINIMUM 75mm DGB20 BASE COMPACTED TO 98% MMDD
- SUBGRADE COMPACTED TO 95%MMDD
- JOINTING ARRANGEMENT AS PER SET OUT PLAN
- STEEL FLOAT FINISH APPLIED TO VEHICLE CROSSING
- ALL DIMENSIONS SHOWN ON DETAIL ARE IN mm

REINFORCED VEHICLE CROSSING (RVC) SECTION
SCALE 1:10 @ A1

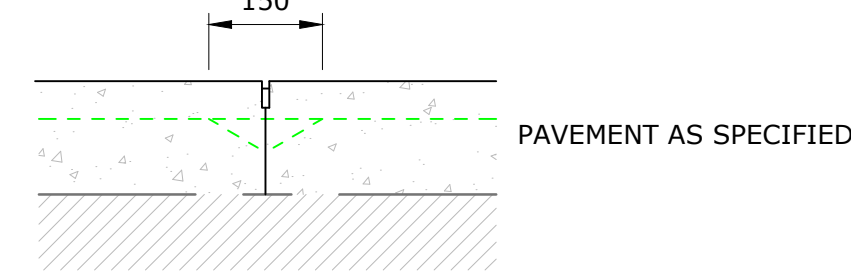

- CUT AND REMOVE 150mm OF ALTERNATE BARS IN REINFORCEMENT CROSSING JOINT.
- 3mm WIDE x 35mm DEEP SAWCUT.
- SAWCUT TO BE MADE ONCE CONCRETE HAS HARDENED SUFFICIENTLY THAT SAWING WILL NOT DAMAGE SURFACE.
- SAWCUT TO BE MADE WITHIN 24 HOURS OF CONCRETE BEING LAID.
- SAWCUT TO BE SEALED WITH BOSTIK SEAL N'FLEX OR EQUIVALENT.
- JOINT LAYOUT AS PER PLAN.

WEAKENED PLANE JOINT (WPJ)
SCALE 1:10 @ A1

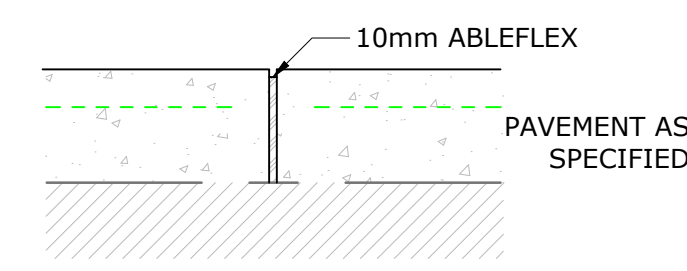

- 10mm ABLEFLEX TO BE INSTALLED ALONG LENGTH OF JOINT.
- TOP OF JOINT TO BE SEALED WITH BOSTIK SEAL N'FLEX OR EQUIVALENT.

EXPANSION JOINT (EJ)
SCALE 1:10 @ A1

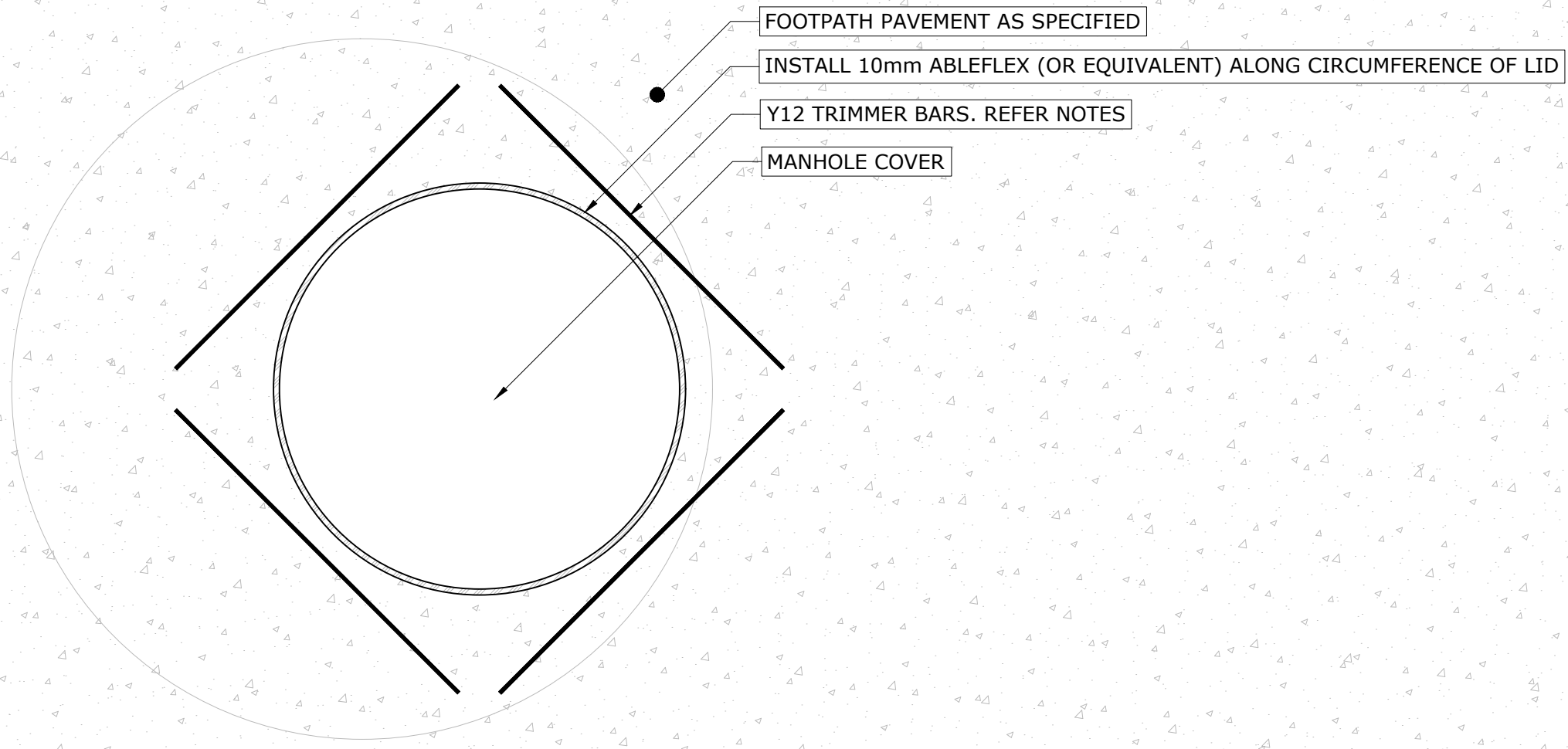

MANHOLES IN FOOTPATHS - TYPICAL CO-ORDINATION DETAIL

1:10 @ A1

- INSTALL Y12 TRIMMER BARS AT 45 DEGREES TO FOOTPATH ORIENTATION.
- LENGTH OF TRIMMER BARS TO BE EQUAL TO OR GREATER THAN DIAMETER OF PENETRATION IN FOOTPATH.
- MINIMUM COVER 50mm.
- TRIMMER BARS INCLUDED TO CONTROL CRACKING AT INTERFACE OF FOOTPATH AND MANHOLE COVER.

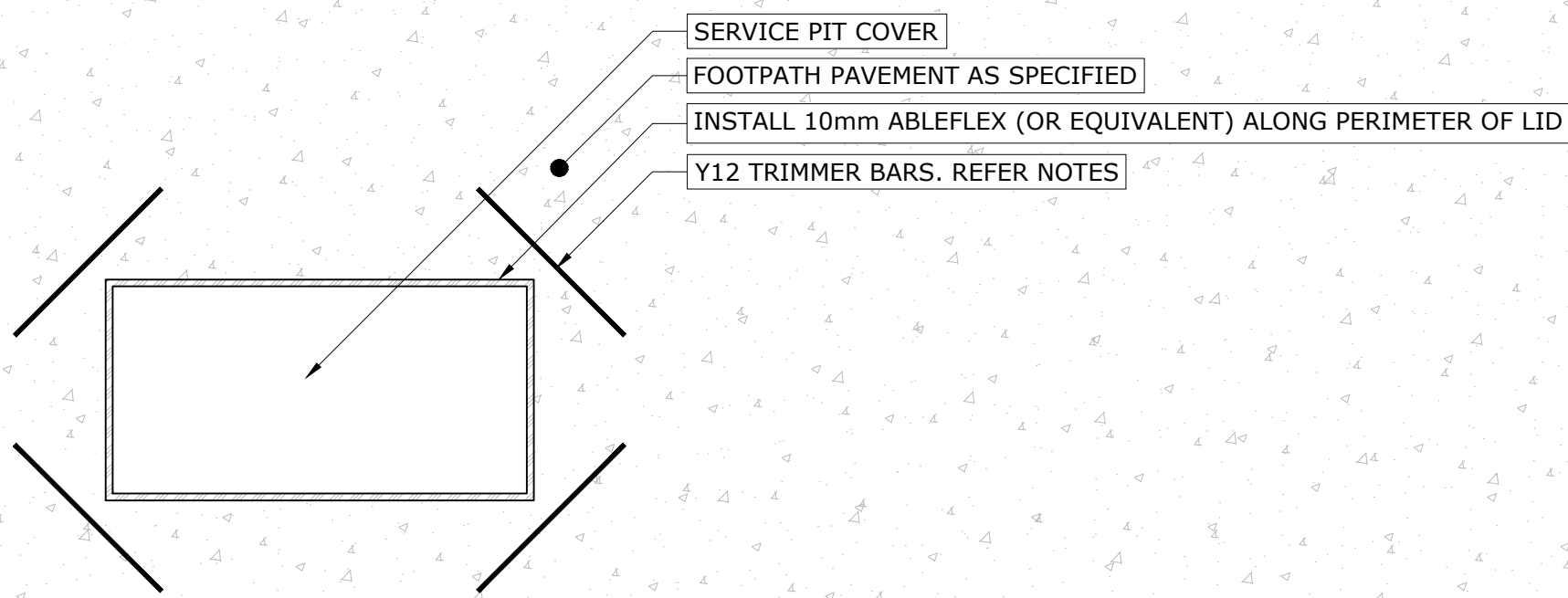

RECTANGULAR SERVICE PITS/VALVE COVERS IN FOOTPATHS - TYPICAL CO-ORDINATION DETAIL

1:10 @ A1

- INSTALL Y12 TRIMMER BARS AT 45 DEGREES TO FOOTPATH ORIENTATION.
- LENGTH OF TRIMMER BARS TO BE EQUAL TO OR GREATER THAN SHORTEST PLAN VIEW DIMENSION OF SERVICE PIT PENETRATION (WIDTH OF LENGTH).
- MINIMUM COVER 50mm.
- TRIMMER BARS INCLUDED TO CONTROL CRACKING AT INTERFACE OF FOOTPATH AND MANHOLE COVER.

DISCIPLINE:
CIVIL SERVICES

REV	ISSUE	CHK'D	APP'D	DATE
1	PRELIMINARY	S.G.	S.G.	25/11/21
2	PRELIMINARY	S.G.	S.G.	02/02/21
3	PRELIMINARY	S.G.	S.G.	29/02/21
4	PRELIMINARY	S.S.	S.S.	16/03/22
5	PRELIMINARY	S.G.	S.G.	18/08/22

ALL DRAWINGS ARE DESIGNED TO BE PRINTED AND READ IN COLOUR. IT IS THE CONTRACTORS' RESPONSIBILITY TO PRINT DRAWINGS IN COLOUR TO AVOID ANY POTENTIAL DISCREPANCIES. IF DRAWINGS ARE PRINTED IN BLACK AND WHITE.



Vital Design Solutions
HYDRAULIC CIVIL FIRE

Canberra - Ground floor, 20 Spongolite Street, Beard ACT 2620
Melbourne - Level 22, 535 Bourke Street, Melbourne Vic 3000
Tel: 02 6297 2785 Email: admin@vdsol.com.au ABN: 45 151 340 788
Fax: 02 6299 2316 Web: vdsol.com.au ACN: 151 340 788

ARCHITECT

CLIENT

PROJECT

**WESTON VILLAGE
BLOCK 1 SECTION 82
UNWIN STREET
WESTON ACT**

DRAWING TITLE

**VERGE WORKS
NOTES AND DETAILS PLAN**

ALL DIMENSIONS ARE TO BE VERIFIED ON SITE PRIOR TO COMMENCEMENT OF WORKS, ORDERING MATERIAL OR PRODUCING SHOP DRAWINGS.

THE COPYRIGHT OF THIS DRAWING REMAINS WITH VITAL DESIGN SOLUTIONS PTY LTD.

JOB REFERENCE: **VS21063**

DRAWING NUMBER: **C.50**

DESIGNED: S.GWYNNE DRAFTED: E.PEARSON

SCALE: **NTS**

SCALE: NTS SIZE: A1

ISSUE: **NOT FOR CONSTRUCTION**

REVISION: **5**