

LINE OF BASEMENT BELOW

SITE AREA: 14,192
 DEEP SOIL AREA: 1,507
 DEEP SOIL PERCENTAGE: 10.6%

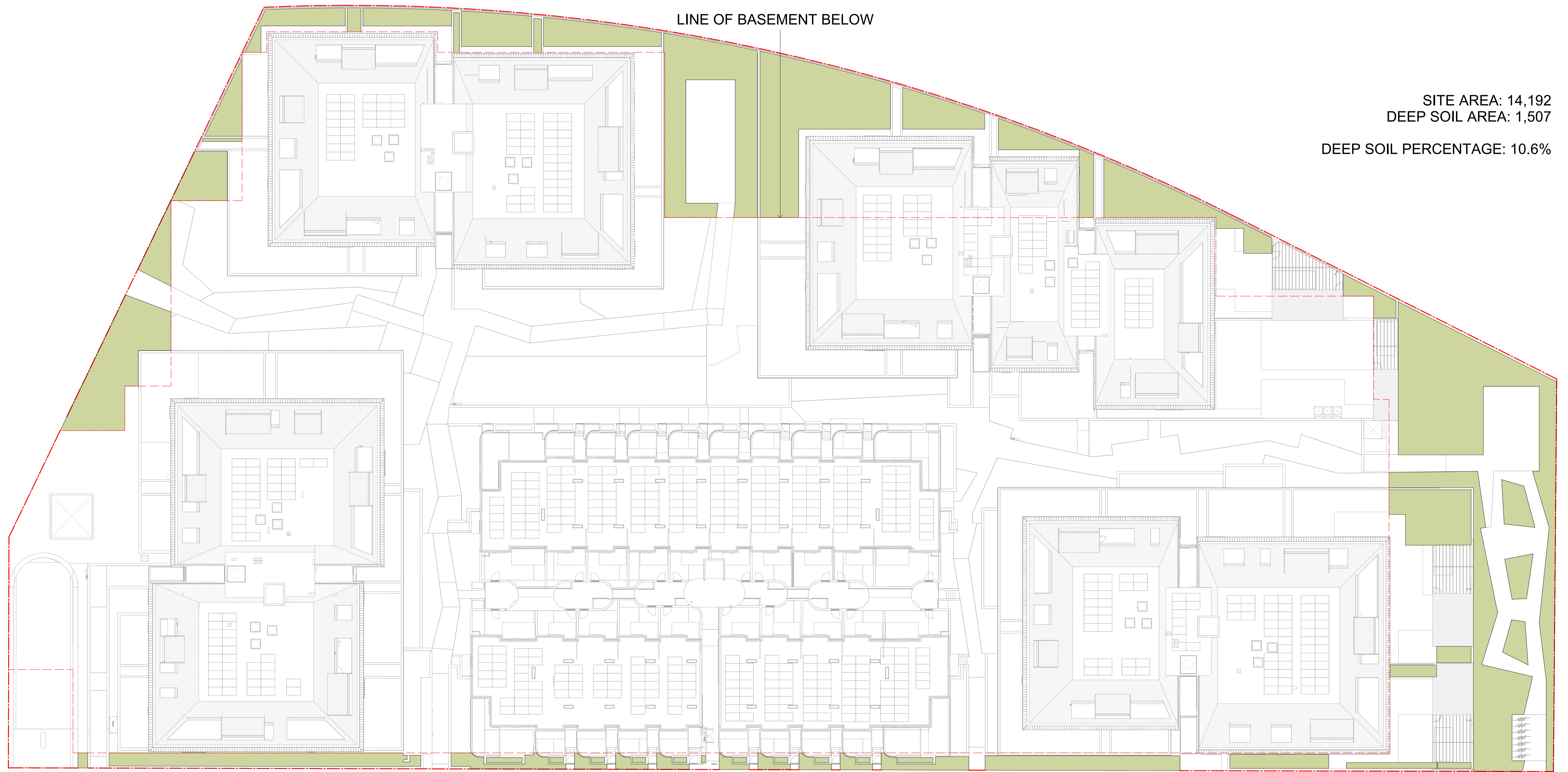

Nominated Architects: Adam Haddow-7188 | John Pradel-7004

In accepting and utilising this document the recipient agrees that SJB Architecture (NSW) Pty. Ltd. ACN 081 094 724 T/A SJB Architects, retain all common law, statutory law and other rights including copyright and intellectual property rights. The recipient agrees not to use this document for any purpose other than as intended; to waive all claims against SJB Architects resulting from unauthorised changes; or to reuse the document on other projects without the prior written consent of SJB Architects. Under no circumstances shall transfer of this document be deemed a sale. SJB Architects makes no warranties of fitness for any purpose. The Builder/Contractor shall verify job dimensions prior to any work commencing. Use figured dimensions only. Do not scale drawings.

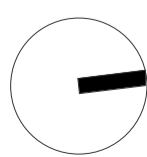

Rev	Date	Description
1	30.06.2023	FOR INFORMATION
2	05.07.2023	FOR INFORMATION
3	11.08.2023	ISSUE FOR DA
4	23.08.2023	ISSUE FOR DA

Revision

By Chk.

Architect
SJB Architects
 Landscape Architect
McGregor Coxall

Electrical Engineer
S4B
 Mechanical Engineer
S4B

Structural Engineer

Sellick
 Hydraulic Engineer
THCS
 Town Planner

Civil Engineer
Sellick

ESD Consultant

DDA/Access Consultant

Traffic Engineer

BCA Consultant

Client

DOMA

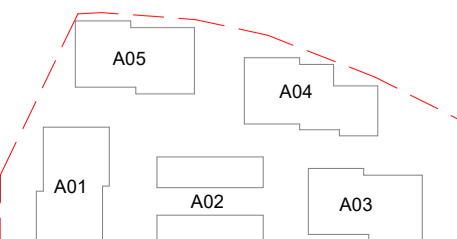

Project

BRICKWORKS Yarralumla, ACT 2600

Building

PRECINCT 1

Drawing Name

Deep Soil Analysis

Date

23.08.2023

Scale

1 : 250

Sheet Size

@ A1

SJB Architects

Drawn

Author

Job No.

5479

Chk.

Checker

Drawing No.

DA-A-3023

Revision

/ 4

Level 2
 490 Crown Street
 Surry Hills NSW
 2010 Australia
 T 61 2 9380 9911
 F 61 2 9380 9922
 www.sjb.com.au



FOR APPROVAL