

PT-1A

**PAVEMENT TYPE 1A
MAIN CARRIAGEWAY
WILLIAM HOVELL DRIVE**
THIN ASPHALT OVER
HEAVY-DUTY
GRANULAR MATERIAL

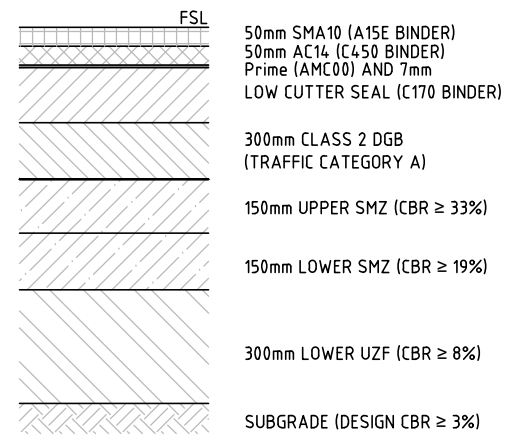

PT-1B

**PAVEMENT TYPE 1B
MAIN CARRIAGEWAY
WILLIAM HOVELL DRIVE**
SMA AND AC14 ASPHALT
OVER HEAVY-DUTY
GRANULAR MATERIAL

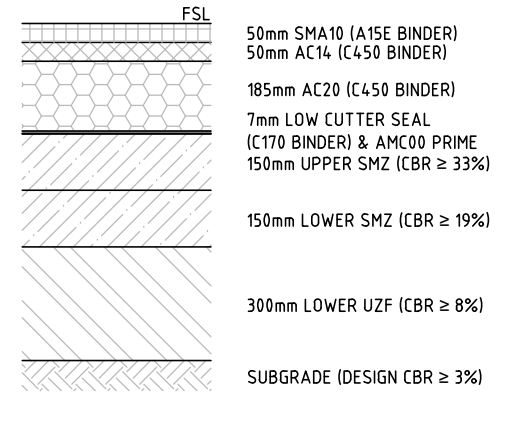

PT-2C

**PAVEMENT TYPE 2C
INTERSECTIONS
WILLIAM HOVELL DRIVE**
FULL DEPTH ASPHALT
WITH AN SMA OVERLAY

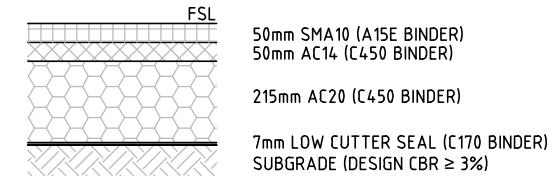

PT-2D

**PAVEMENT TYPE 2D
INTERSECTIONS
WILLIAM HOVELL DRIVE**
FULL DEPTH ASPHALT
WITH AN SMA OVERLAY

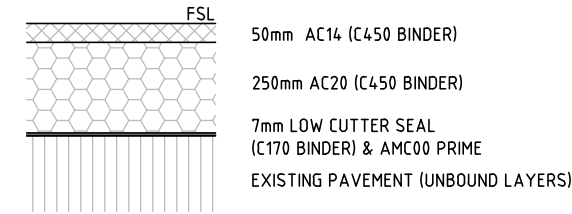

PT-3

**PAVEMENT TYPE 3
MAIN CARRIAGEWAY
WILLIAM HOVELL DRIVE**
ASPHALT INLAY
(HEAVY PATCHING)

REFER TO ACTSD-0501
CONCRETE PATH DETAILS

PT-4

**PAVEMENT TYPE 4
PEDESTRIAN PATH**
REFER NOTES 6 TO 9

REFER TO ACTSD-0501
ASPHALT PATH DETAILS

PT-5

**PAVEMENT TYPE 5
SHARED USER PATH**

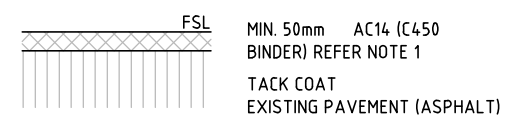

PT-6A

**PAVEMENT TYPE 6A
MILL AND RESHEET**



PT-6B

**PAVEMENT TYPE 6B
ASPHALT OVERLAY**

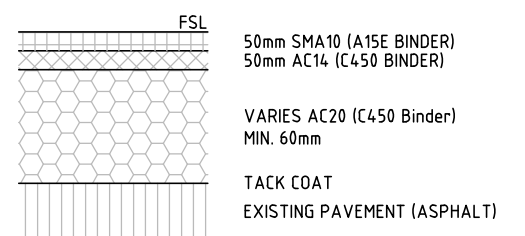

PT-6C

**PAVEMENT TYPE 6C
SMA10 AND AC14
ASPHALT OVERLAY**



PT-7

**PAVEMENT TYPE 7
CONCRETE MEDIAN**

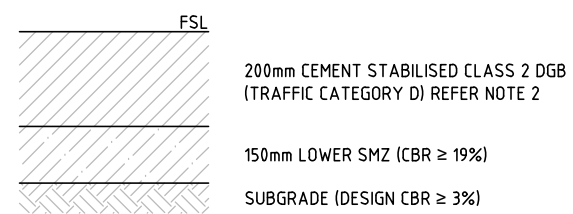

PT-8

**PAVEMENT TYPE 8
GRANULAR MATERIAL
WEARING COURSE
CEMETERY ACCESS ROAD**



PT-9

**PAVEMENT TYPE 9
DECOMPOSED GRANITE
MEDIAN**

- NOTES:**
- POLYMER MODIFIED BINDER (A15E BINDER) MUST BE USED FOR RUT RESISTANCE AT APPROACHES TO SIGNALISED INTERSECTIONS.
 - STABILISE CLASS 2 DGB (TRAFFIC CATEGORY D) WITH 2% CEMENT BY MASS TO MINIMIZE SCOUR.
 - PROVIDE 150mm HBB SLAG TO R73 WORKING PLATFORM WHERE EXPOSED SUBGRADES ARE ENCOUNTERED. NO WORKING PLATFORM IS REQUIRED IF THE EXISTING PAVEMENT EXCEEDS 150mm.
 - TO BE USED IN AREAS WITH GRADIENT LESS THAN 5%.
 - EXTENT OF PT-3 TO BE ADJUSTED DURING CONSTRUCTION BY CLOSER SPACING FWD SURVEY AND VISUAL CONDITION ASSESSMENT.
 - EXPANSION JOINTS (EJ) ARE TO BE SEALED WITH 12 MM JOINTEX FOR THE FULL DEPTH OF THE PAVING. FOOTPATH EJ'S TO BE LOCATED ADJACENT TO ALL STRUCTURES, SERVICE PITS, KERB JOINTS AND CROSSINGS, ELSEWHERE AT 5M CENTRES (UNLESS OTHERWISE SPECIFIED OR DIRECTED)
 - WEAKENED PLANE JOINTS (WJ) TO BE 3mm WIDE AND TO 1/4 OF THE DEPTH OF PAVING. SPACING OF WJ'S IS TO APPROXIMATE THE WIDTH OF TP.ATH.
 - CONCRETE PATH JOINTS TO BE PROVIDED AGAINST EXISTING CONCRETE CONSTRUCTION EXCEPT WHERE EJ'S ARE SPECIFIED
 - BROOMED FINISH TO BE APPLIED TO CONCRETE PATH.

150 mm ON ORIGINAL

150
140
130
120
110
100
90
80
70
60
50
40
30
20
10
0

DRAWING FILE LOCATION / NAME V:_Vault\Projects\3002750\CAD\DWG\10_PV_Pavement\3002750-PV-1731.dwg			PLOT DATE 24 May 2024		TIME 10:20:03	
EXTERNAL REFERENCE FILES 3002750_SMEC.dwg V:_Vault\Projects\3002750\CAD\DWG\10_PV_Pavement\3002750-PV-1731.dwg V:_Vault\Projects\3002750\CAD\DWG\10_PV_Pavement\3002750-PV-1731.dwg V:_Vault\Projects\3002750\CAD\DWG\10_PV_Pavement\3002750-PV-1731.dwg	REV	DATE	AMENDMENT / REVISION DESCRIPTION	WVR No.	APPROVAL	TITLE
	A	19.06.2020	PRELIMINARY SKETCH PLAN	0007	DK	DRAFTER <i>N. BROOKE-TAYLOR</i>
	B	08.10.2020	PRELIMINARY SKETCH PLAN	0014	DK	DRAFTING CHECK <i>X. SECUBAN</i>
	C	13.11.2020	PRELIMINARY SKETCH PLAN SUBMISSION	0015	DK	DESIGNER <i>N. GALE</i>
	D	29.02.2024	DRAFT DOCUMENT READINESS (DR) SUBMISSION	0036	T.VN	DESIGN CHECK <i>J. MEYER</i>
	E	24.05.2024	FINAL DOCUMENT READINESS (DR) SUBMISSION	0037	T.VN	PROJECT MANAGER <i>K. DECANHA</i>
SCALES AT A1 SIZE DRAWING				DESIGNER SMEC Member of the Surlana Jurong Group ABN 47 065 475 149		
SCALE 1:10				CLIENT ACT Government Transport Canberra & City Services		
PROJECT TITLE WILLIAM HOVELL DRIVE DUPLICATION				PROJECT / DRAWING No. 3002750-PV-1731		
PAVEMENT DETAILS SHEET 1				REVISION E		

DR