

File Name: P:\2019\191148_Yarralumla-Brickworks\04_CAD\4.2_Drawings\CIV\EDP\191148-drg-civ-18-01.dwg

Status

NOT FOR CONSTRUCTION

DO NOT SCALE OFF DRAWINGS. VERIFY ALL DIMENSIONS ON SITE PRIOR TO WORK.
 COPYRIGHT: The contents and information contained in this document are copyright of Sellick Consultants. Use or copy of this document in whole or part without written permission constitutes an infringement of copyright.

| Rev | Description | Date | Drawn By |
|-----|------------------------|------------|----------|
| S | EDP SUBMISSION | 10.08.2023 | MN |
| R | EDP SUBMISSION | 31.07.2023 | MN |
| Q | EDP SUBMISSION | 10.07.2023 | MN |
| P | EDP SUBMISSION | 22.06.2023 | RT |
| O | EDP SUBMISSION | 16.06.2023 | RT |
| N | EDP DRAFT REVIEW | 14.06.2023 | RT |
| M | EIS COMMENTS ADDRESSED | 11.10.2022 | RT |

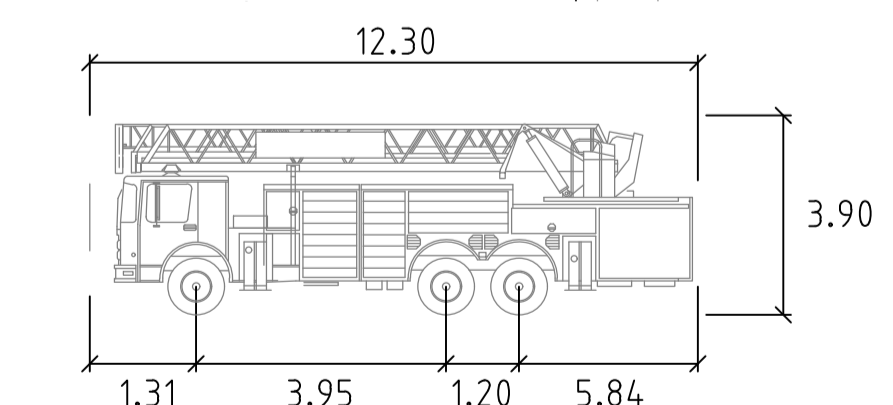
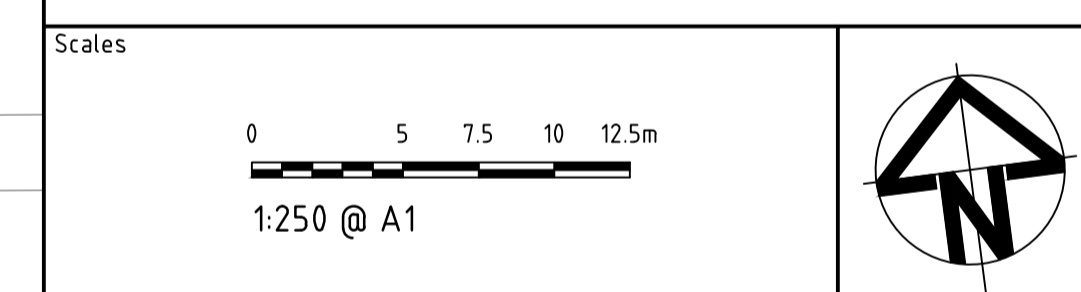
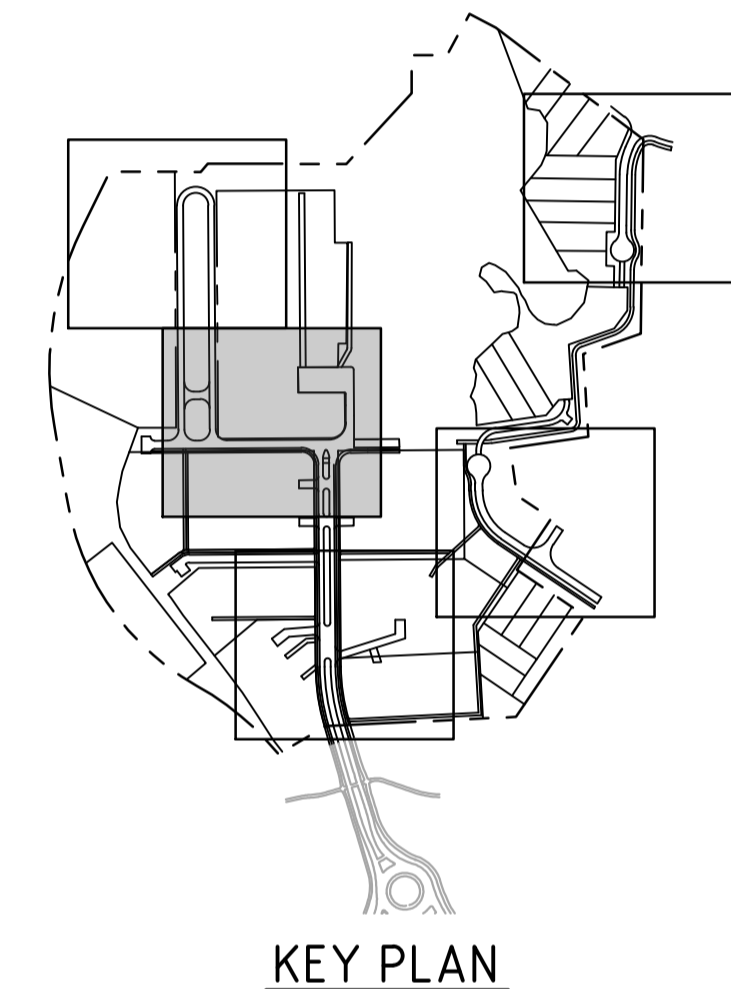
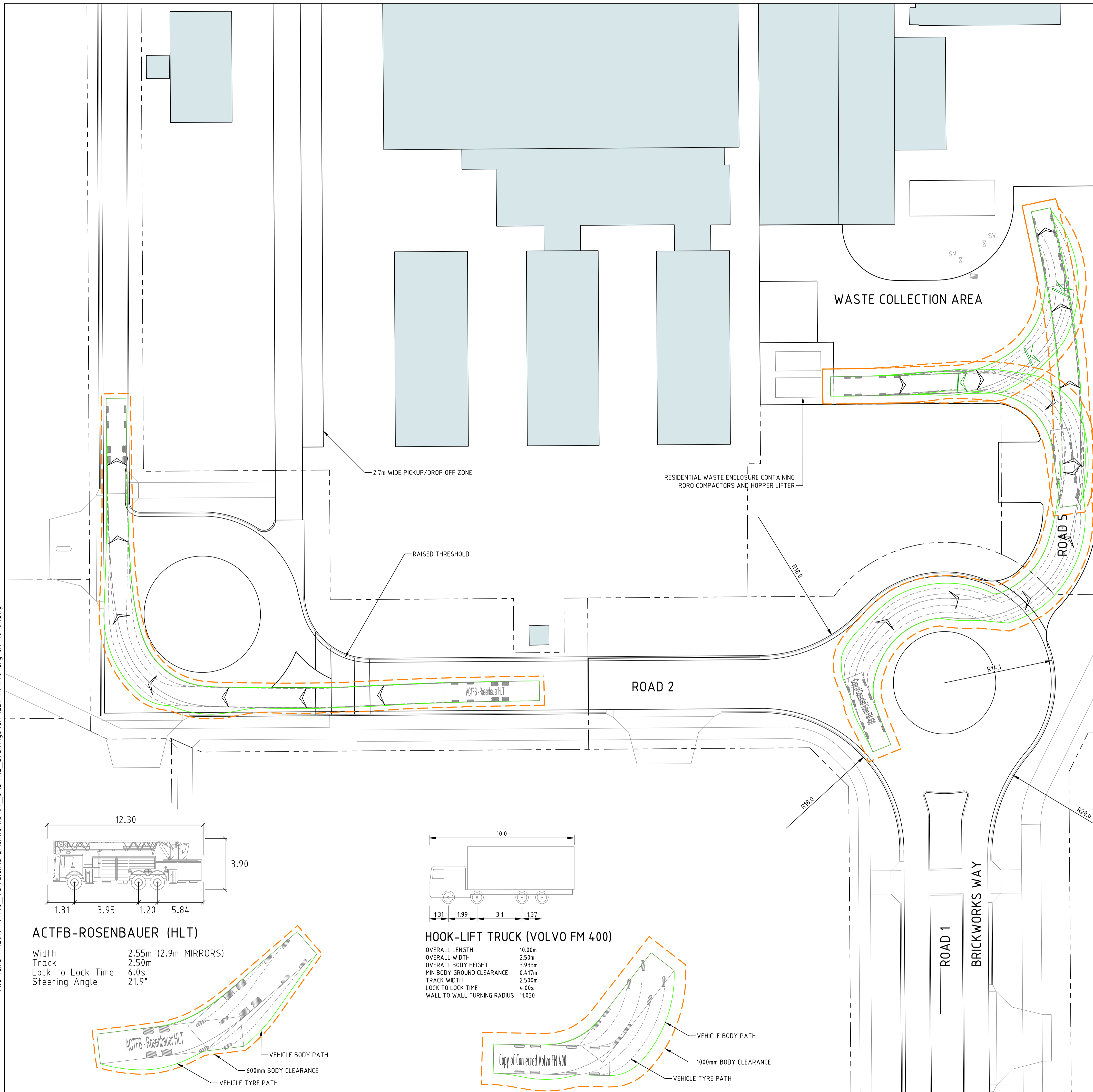

ACTFB-ROSENBAUER (HLT)
 Width: 2.55m (2.9m MIRRORS)
 Track: 2.50m
 Lock to Lock Time: 6.0s
 Steering Angle: 21.9°

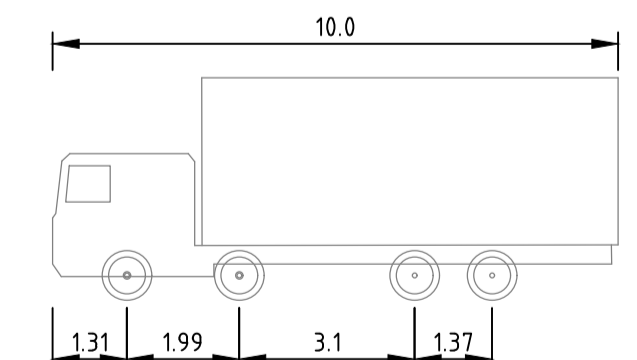

HOOK-LIFT TRUCK (VOLVO FM 400)
 OVERALL LENGTH: 10.00m
 OVERALL WIDTH: 2.50m
 OVERALL BODY HEIGHT: 3.933m
 MIN BODY GROUND CLEARANCE: 0.417m
 TRACK WIDTH: 2.500m
 LOCK TO LOCK TIME: 4.00s
 WALL TO WALL TURNING RADIUS: 11.030

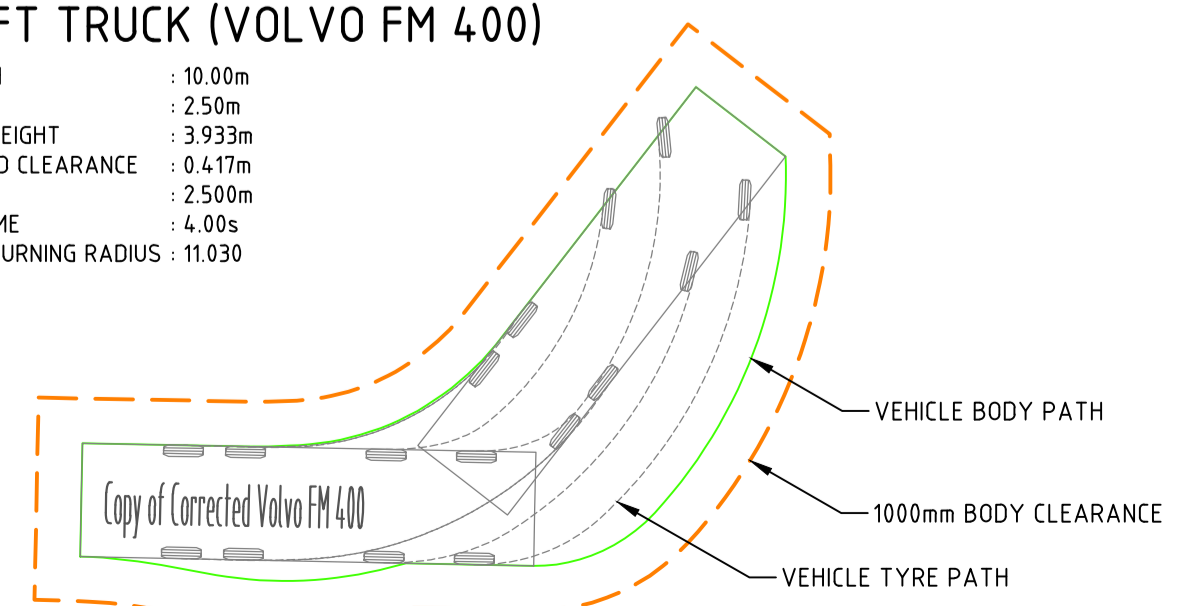
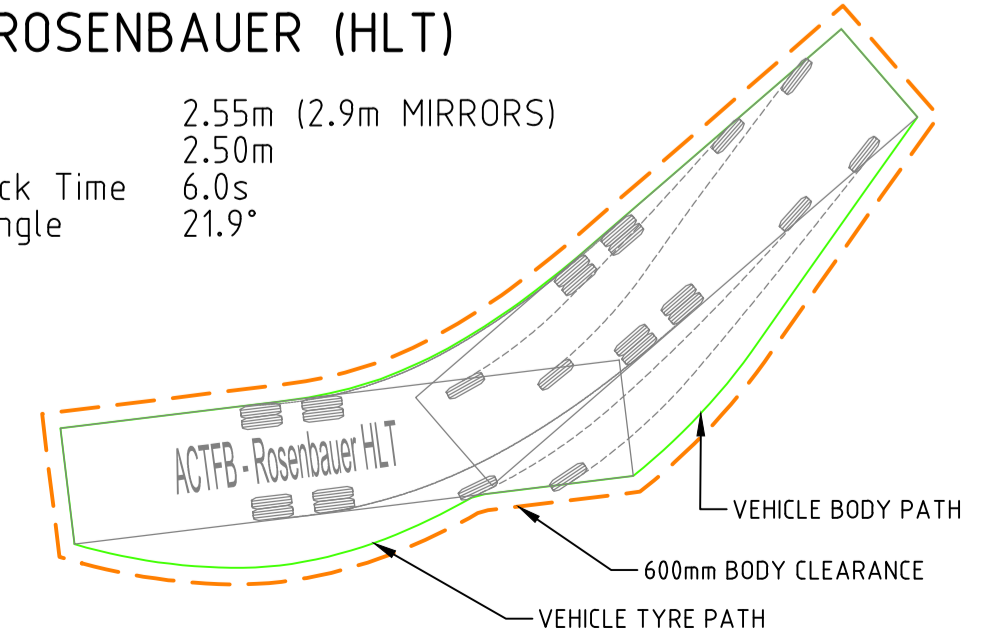

| | | | | | |
|-------------------|--------------|--------------------|----|----------------|------------|
| Original Size | A1 | Drawn By | DA | Drafting Check | DCA |
| Date Plotted | 10-Aug-23 | Designed By | AE | Design Check | BC |
| Coordinate System | STROMLO GRID | Approved | BC | Approved Date | 16/12/2019 |
| Height Datum | AHD | Approved Signature | | | |

Project Name and Location
THE CANBERRA BRICKWORKS
 BLOCKS 1,7 & 20 SECTION 102

Drawing Title
EDP - ROADS DETAIL AND VEHICLE DEMONSTRATIONS PLAN SHEET 1

| Project Number | Type | Discipline | Drg No. | Sub-No. | Rev |
|----------------|------|------------|---------|---------|-----|
| 191148 | DRG | CIV | 18 | 01 | S |