

NOTES:

EXISTING TREES

All trees are to be retained.  
Existing crown clearances not to be altered.  
Ensure construction equipment can pass beneath lowest limbs.  
Crowns and apex of canopy not to be altered or reduced.

SERVICE ENTRY TO SITE

All trenching work to verges to be submitted to city parks for approval.  
Number of verge crossings to be minimized.

FENCING

Fence off existing trees beneath the extent of the crown spread or along kerbs.  
Use 1800mm high chain mesh fence.  
Fencing to be erected on the commencement of construction and removed at the commencement of landscaping.

STORAGE OF MATERIALS

No construction materials are to be stored on the verge.  
No car parking or equipment parking permitted on verges.

RESTORATION WORK

Verge to be completely reinstated on completion including grading, grassing and/or turf to city parks requirements.

NOTES FROM LANDSCAPE DESIGN & CONSTRUCTION GUIDELINES

Do not excavate within the feeder zone of any mature Eucalyptus species.  
All work within the drip zone must be undertaken by hand.  
Do not sever large roots (>30mm diameter) closer than halfway from drip line to the trunk.  
All roots must be cut cleanly with equipment specifically designed to cut roots or other pruning equipment.  
Roots exposed during excavation must be protected from desiccation.  
Excavation occur within the drip zone of a tree is to be restricted to one side of the tree only.



SEDIMENT AND EROSION CONTROL

The Development is to comply with the ACT Environment Protection Authority, Environment Protection Guidelines for Construction and Land Development in the ACT, August 2007

Install sediment control barriers where required to prevent sediment discharge, prevent stormwater from leaving the site where practicable.

Maintain all control measures during construction and until full stabilization/ completion of landscaping.

Regularly remove any sediment from roads adjacent to the site if required.

The site must have appropriate erosion and sediment control measures in place prior to works commencing to ensure soil or other wastes do not leave the site and enter the stormwater system. this includes, where necessary, geotextile silt fencing and hay bale filters. silt fencing, on its own or incorporating hay bale filters, must be installed along the lower side of the site to prevent discharge of sediment off site. shade cloth is not adequate.

1.8m HIGH SEDIMENT AND PERIMETER FENCING AROUND VERGE

1.8m HIGH SEDIMENT AND PERIMETER FENCING

1.8m HIGH SEDIMENT AND PERIMETER FENCING

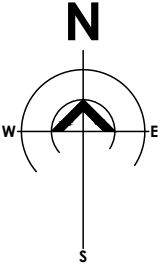
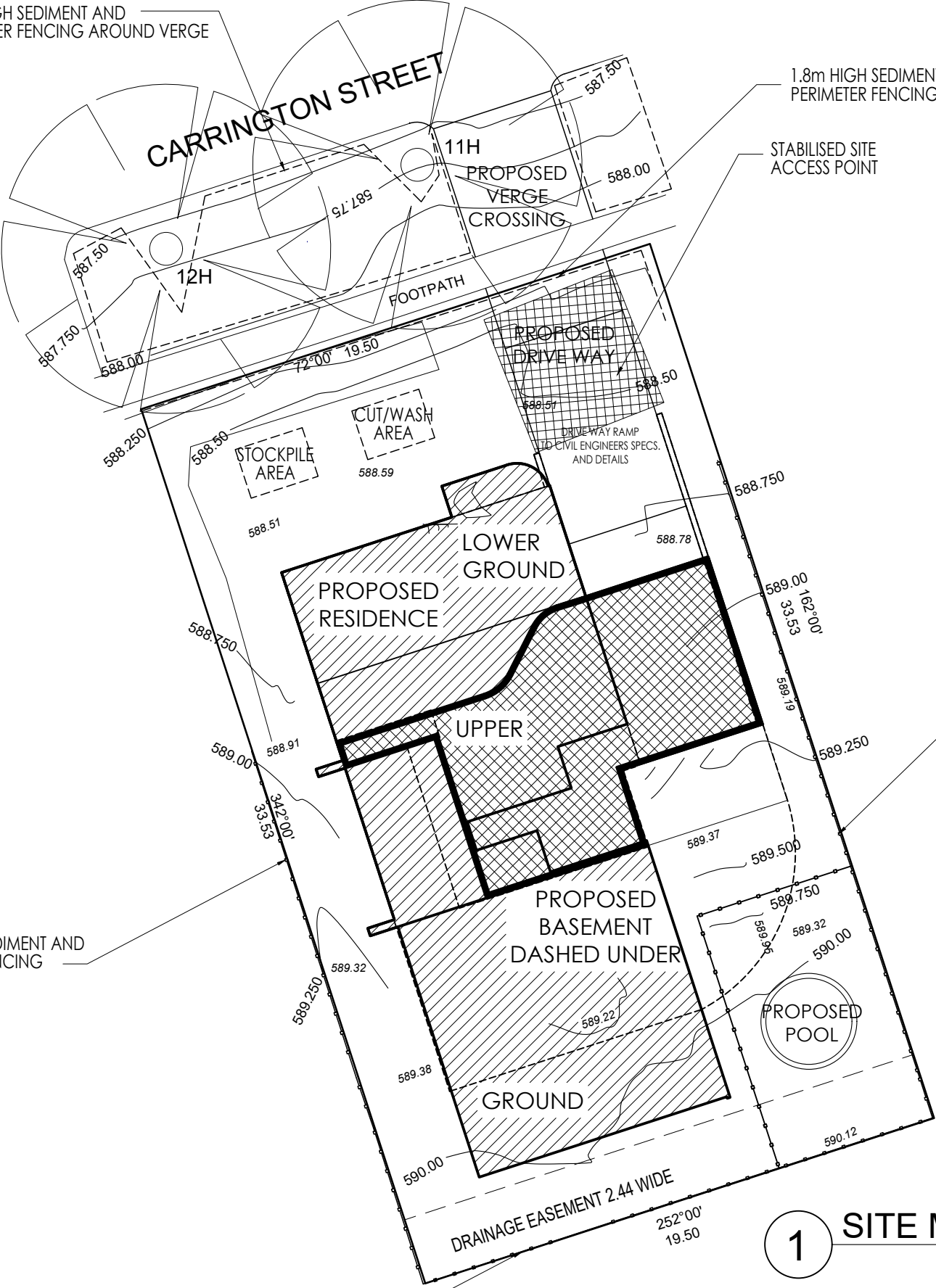

1.8m HIGH SEDIMENT AND PERIMETER FENCING

1 SITE MANAGEMENT PLAN

NOTE - IT IS THE CLIENT/OWNERS, BUILDER AND CONTRACTORS OBLIGATION TO READ THROUGH THE FULL SET OF PLANS PROVIDED THOROUGHLY PRIOR TO ANY CONSTRUCTION OR WORKS.

BUILDER/CONTRACTORS TO CONFIRM DIMENSIONS ONSITE PRIOR TO COMMENCEMENT OF WORKS.

NOTE: ALL WORK TO BE DONE IN ACCORDANCE WITH THE NCC, AUS. STANDARDS, SDHDC ACT AND LIVABLE HOUSING DESIGN STANDARD 2022

adrianodambrosio  
design & drafting

E-mail // adrianodambrosio@outlook.com  
Mobile // 0433 237 246



PROPOSED RESIDENCE // SUBURB // DEAKIN

SHEET TITLE // SITE MANAGEMENT PLAN  
BLOCK // 16  
SECTION // 21  
DATE // 5 AUG 2023

CLIENT // BRUCIC  
SCALE // 1:200 @ A3  
DATE // 5 AUG 2023

REVISION // A

DWG No // A12