

In accepting and utilising this document the recipient agrees that SJB Architecture (NSW) Pty Ltd, ACN 081 094 724 T/A SJB Architects, retain all common law, statutory law and other rights including copyright and intellectual property rights. The recipient agrees not to use this document for any purpose other than its intended use; to waive all claims against SJB Architects resulting from unauthorised changes; or to reuse the document on other projects without the prior written consent of SJB Architects. Under no circumstances shall transfer of this document be deemed a sale. SJB Architects makes no warranties of fitness for any purpose. The Builder/Contractor shall verify job dimensions prior to any work commencing. Use figured dimensions only. Do not scale drawings.
 Nominated Architects: Adam Haddow-7165 | John Pradel-7004

FOR APPROVAL

Rev	Date	Revision	By	Chk.
1	14.06.2023	FOR INFORMATION	EW	JL
2	21.06.2023	ISSUE FOR EDP SUBMISSION	EW	JL

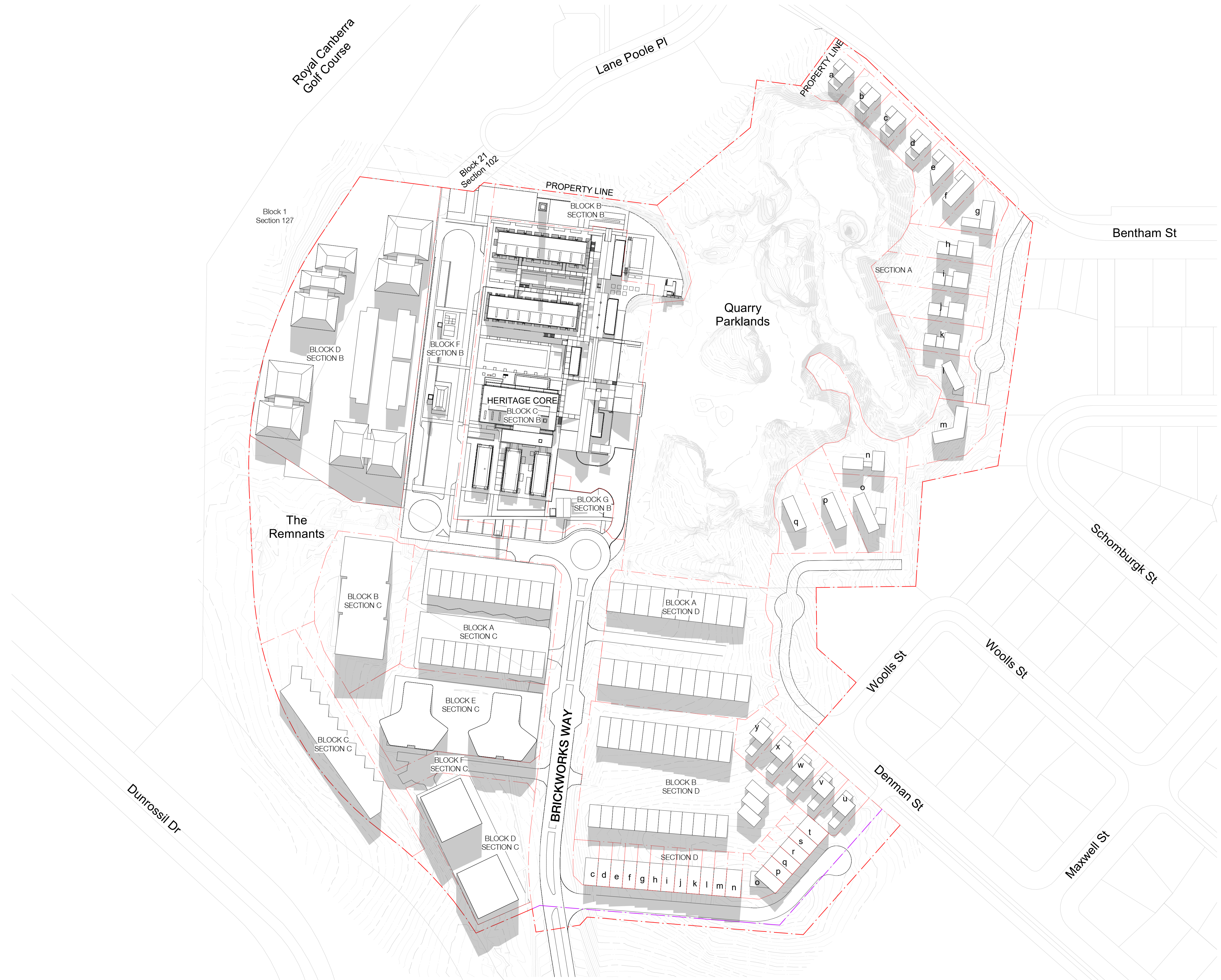

Client

DOMAGROUP

Project
YARRALUMLA BRICKWORKS

Building
SITE WIDE

Drawing Name
SHADOW PLAN - WINTER SOLSTICE 12PM

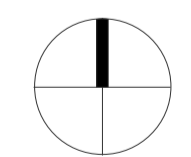

Date
 21.06.2023

Scale
 1 : 1000

Sheet Size
 @ A1

Drawn
JL

Chk.
EW

Job No.
5479

Drawing No.
DA-X-2402 2

Revision

SJB Architects
 Level 2
 490 Crown Street
 Surry Hills NSW
 2010 Australia
 T 61 2 9380 9911
 F 61 2 9380 9922
 www.sjb.com.au

