

SHADOW PLAN - JUNE 21, 9.00

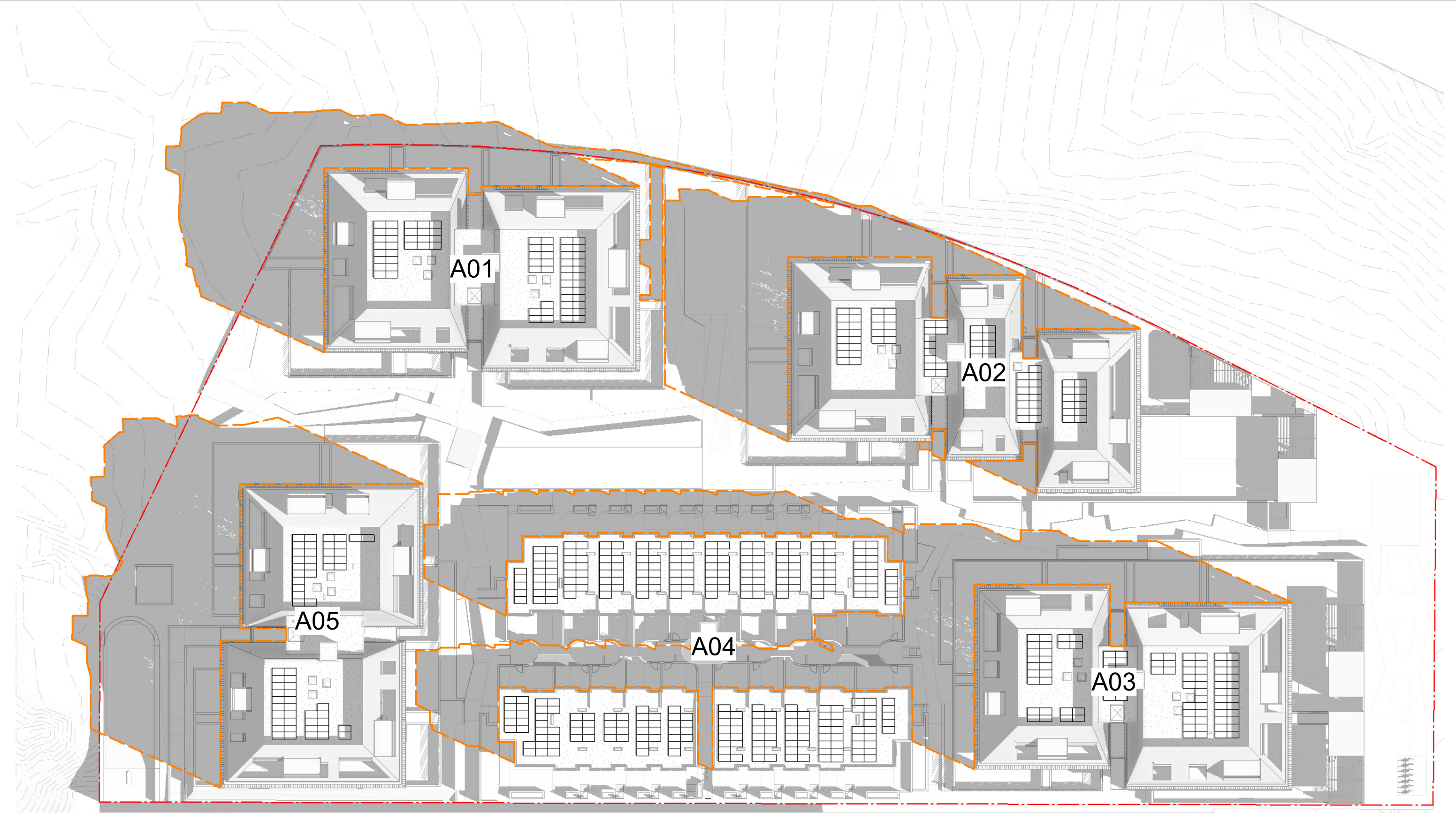

SHADOW PLAN - JUNE 21, 10.00

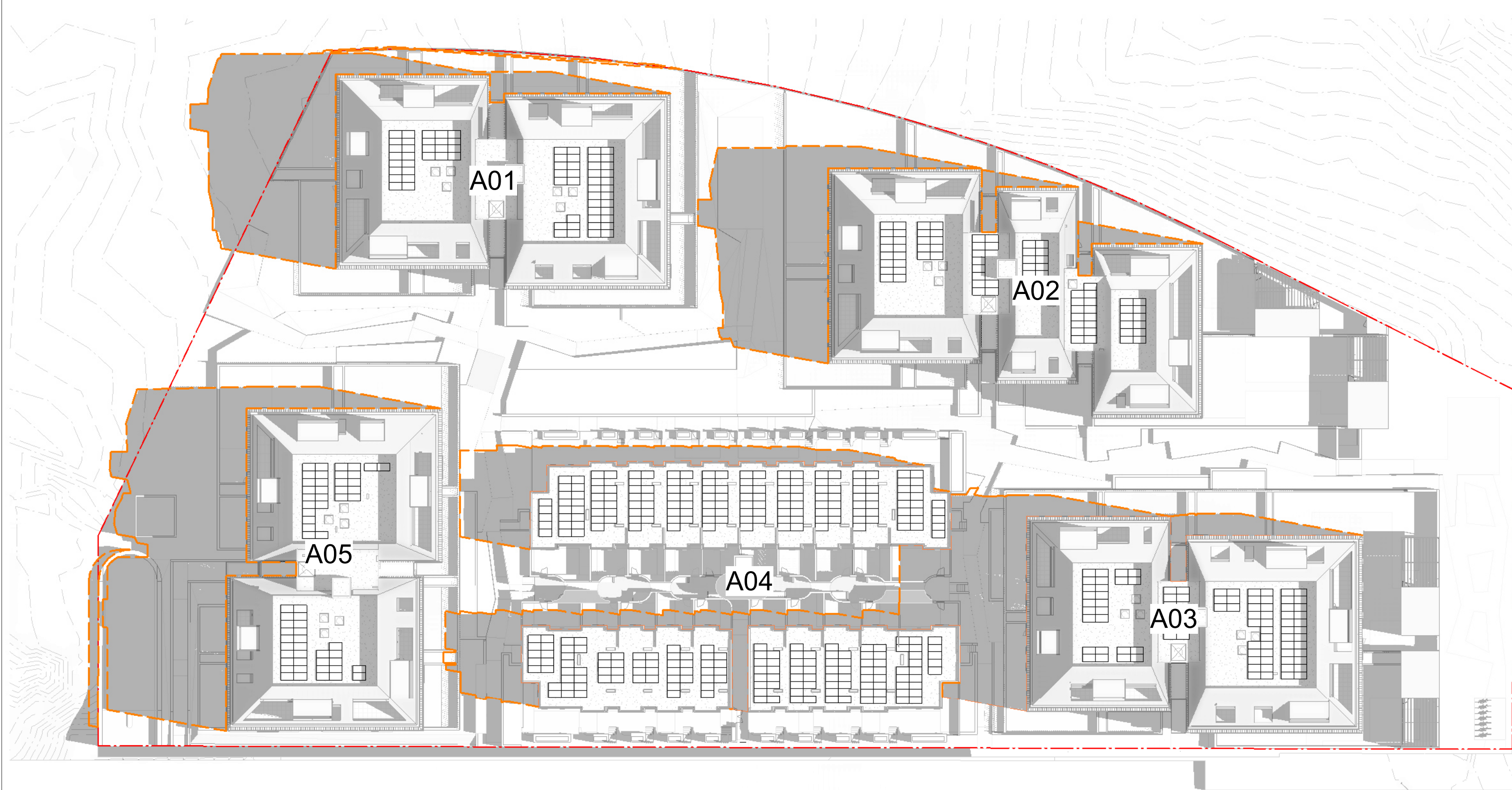

SHADOW PLAN - JUNE 21, 11.00

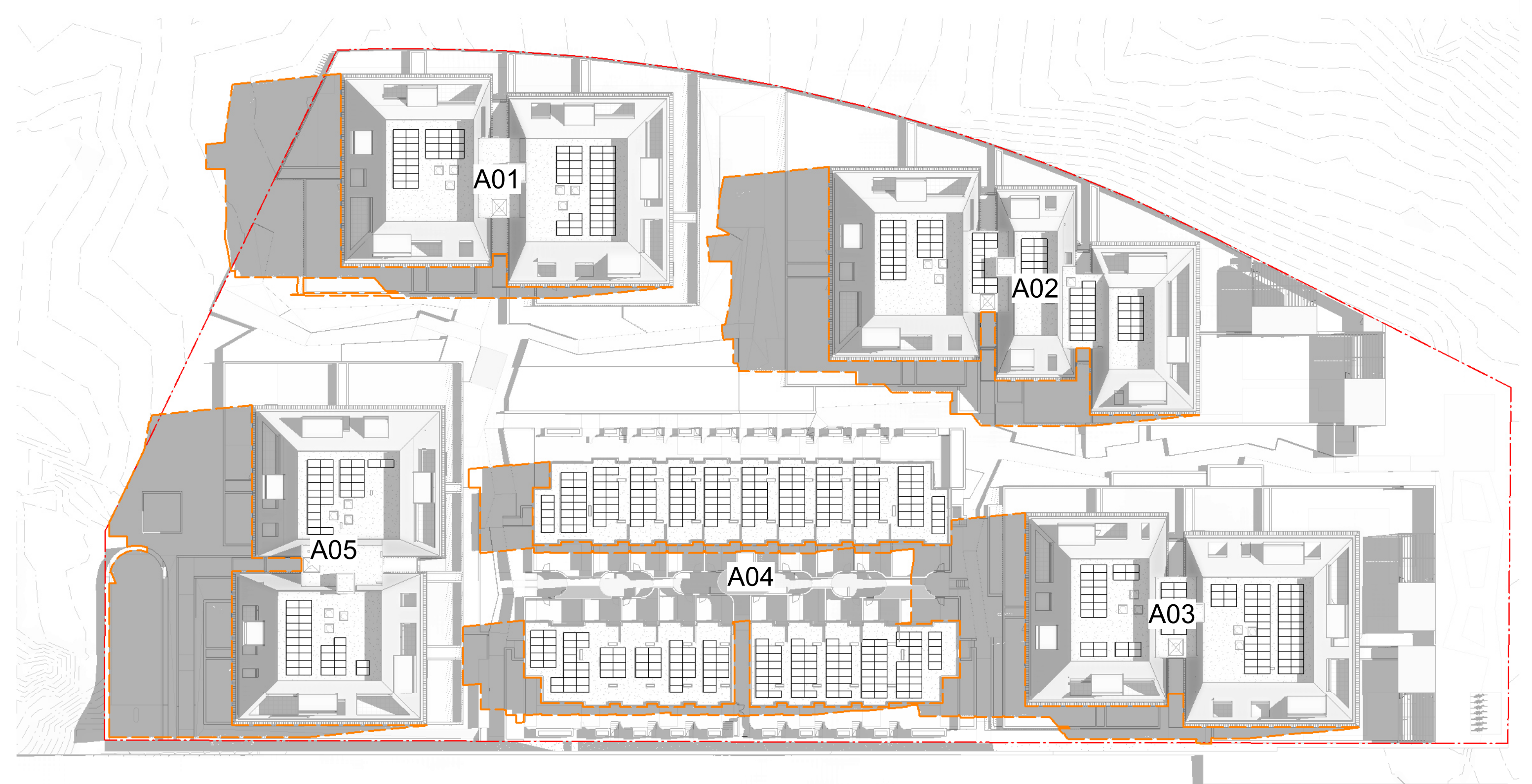

SHADOW PLAN - JUNE 21, 12.00

Nominated Architects: Adam Haddow-7188 | John Pradel-7004

In accepting and utilising this document the recipient agrees that SJB Architecture (NSW) Pty. Ltd. ACN 081 094 724 T/A SJB Architects, retain all common law, statutory law and other rights including copyright and intellectual property rights. The recipient agrees not to use this document for any purpose other than as intended, or to waive all claims against SJB Architects resulting from unauthorised changes, or to reuse the document on other projects without the prior written consent of SJB Architects. Under no circumstances shall transfer of this document be deemed a sale. SJB Architects makes no warranties of fitness for any purpose. The Builder/Contractor shall verify job dimensions prior to any work commencing. Use figured dimensions only. Do not scale drawings.

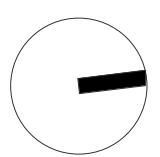

Rev	Date	Revision
1	30.06.2023	FOR INFORMATION
2	05.07.2023	FOR INFORMATION
3	11.08.2023	ISSUE FOR DA
4	23.08.2023	ISSUE FOR DA

By	Chk.
SC	JL
SC	JL
DM	DM
JL	DM

Architect	Structural Engineer
SJB Architects	Sellick
Landscape Architect	Hydraulic Engineer
McGregor Coxall	THCS
Electrical Engineer	Town Planner
S4B	
Mechanical Engineer	Civil Engineer
S4B	Sellick

ESD Consultant	
DDA/Access Consultant	
Traffic Engineer	
BCA Consultant	

Client
DOMA

Project	BRICKWORKS Yarralumla, ACT 2600
Building	PRECINCT 1
Drawing Name	Shadow Diagram

Date	Scale	Sheet Size	SJB Architects
23.08.2023	1 : 500	@ A1	
Drawn	Chk.		
Author	Checker		
Job No.	Drawing No.	Revision	
5479	DA-A-3001	/ 4	

Level 2
490 Crown Street
Surry Hills NSW
2010 Australia
T 61 2 9380 9911
F 61 2 9380 9922
www.sjb.com.au



FOR APPROVAL