

THE PINNACLE NATURE RESERVE

NOTES:

1. STREET LIGHTING CABLING TO BE RETICULATED THROUGH THE BRIDGE BARRIER WHERE POSSIBLE. WHERE THIS CANNOT BE ACCOMMODATED, PROVIDE SURFACE MOUNTED STEEL CONDUIT, MOUNTED IN A DISCRETE LOCATION.
2. CABLING TO THE UNDERPASS LIGHTING TO BE CAST INTO THE NEW SECTION OF THE UNDERPASS WHERE POSSIBLE. PROVIDE SURFACE MOUNTED STEEL CONDUIT IN ALL OTHER LOCATIONS. THE STEEL CONDUIT SHALL BE MOUNTED IN A DISCRETE LOCATION.

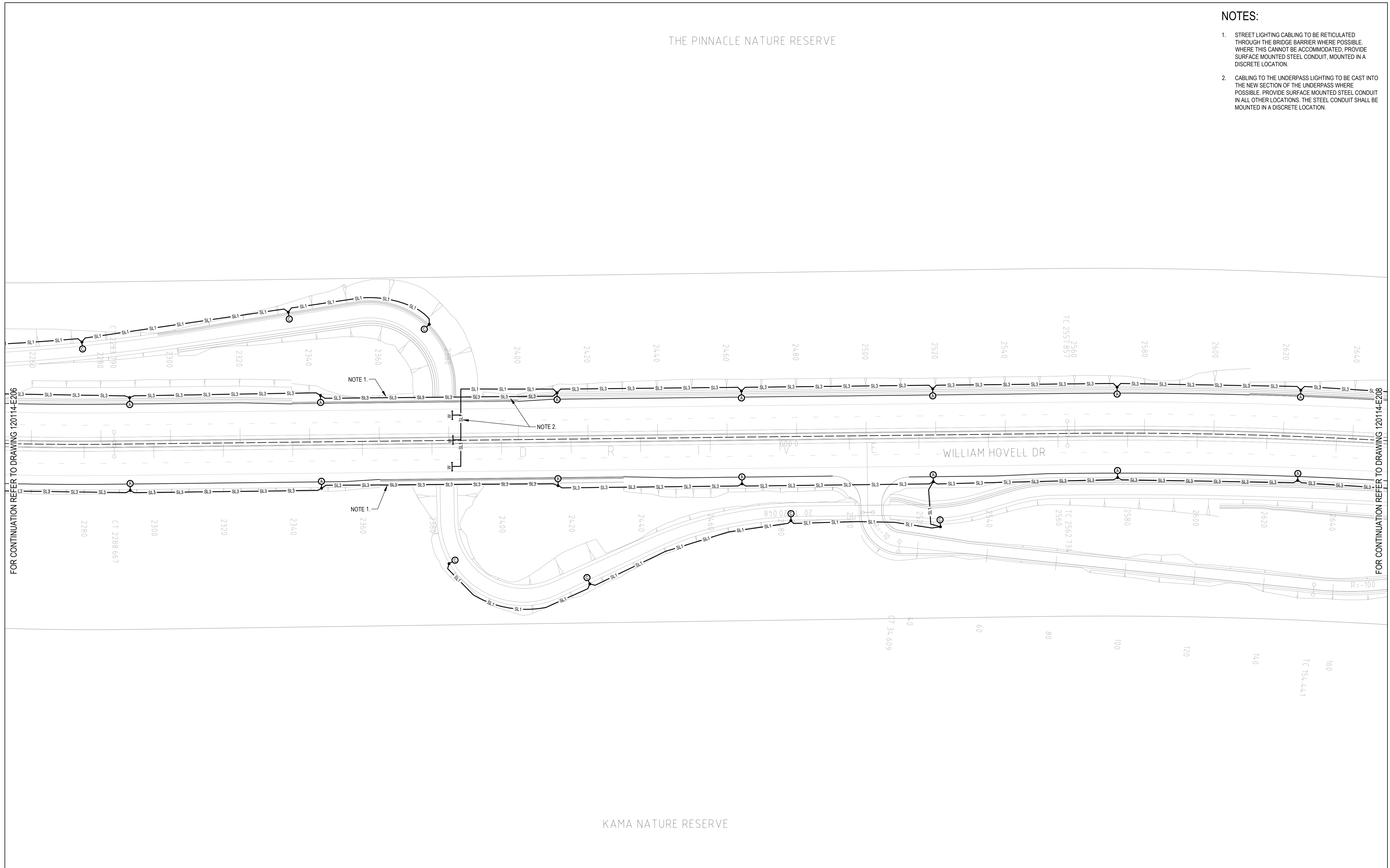

FOR CONTINUATION REFER TO DRAWING 120114-E206

FOR CONTINUATION REFER TO DRAWING 120114-E208

KAMA NATURE RESERVE

Rev.	Date	Details and Status	By	Rev.	Date	Details and Status	By
05	11.10.21	DRAFT DOCUMENT READINESS	JT				
04	13.11.20	ISSUE FOR FINAL PSP	NF				
03	13.10.20	REISSUE FOR PSP (BACKGROUND UPDATE)	NF				
02	09.10.20	REISSUE FOR PSP (BACKGROUND UPDATE)	DO	07	08.03.24	REISSUE FOR DRAFT DR	JT
01	19.06.20	ISSUE FOR PSP	NF	06	16.06.22	REISSUE FOR DRAFT DOCUMENT READINESS	JT

FOR LEGEND REFER TO DRAWING 120114-E001

**NOT FOR TENDER**

© COPYRIGHT of this design and plan is the property of ACOR Rudds Consultants Pty Ltd. ACN 054 221 162, all rights reserved. It must not be used, modified, reproduced or copied wholly or in part without written permission from ACOR Rudds Consultants Pty Ltd. ACOR Rudds Consultants is a trademark licensed to ACOR Rudds Consultants Pty Ltd by ACOR Consultants Pty Ltd.

**ACOR Rudds Consultants Pty Ltd**  
Unit 1, 5 Bodalla Place  
Fyshwick ACT 2609  
T +61 2 6240 2900

ENGINEERS | MANAGERS | INFRASTRUCTURE PLANNERS | DEVELOPMENT CONSULTANTS

Designed A. Bencke	Reviewed / Date M. O'Connor 08.03.24	Approved / Date A. Bencke 08.03.24
Drawn J. Thilakasiri	AutocAD Drawing 120114-E207 [07]	

Client  
**SMEC AUSTRALIA PTY LTD**

Project  
**WILLIAM HOVELL DRIVE  
DUPLICATION**

Drawing Title <b>NEW - STREET LIGHTING SHEET 8 ELECTRICAL SERVICES</b>			
Scale 1:500	Sht Size A1	Drawing No. <b>120114-E207</b>	Rev. <b>07</b>