

PLAN  
1:1500

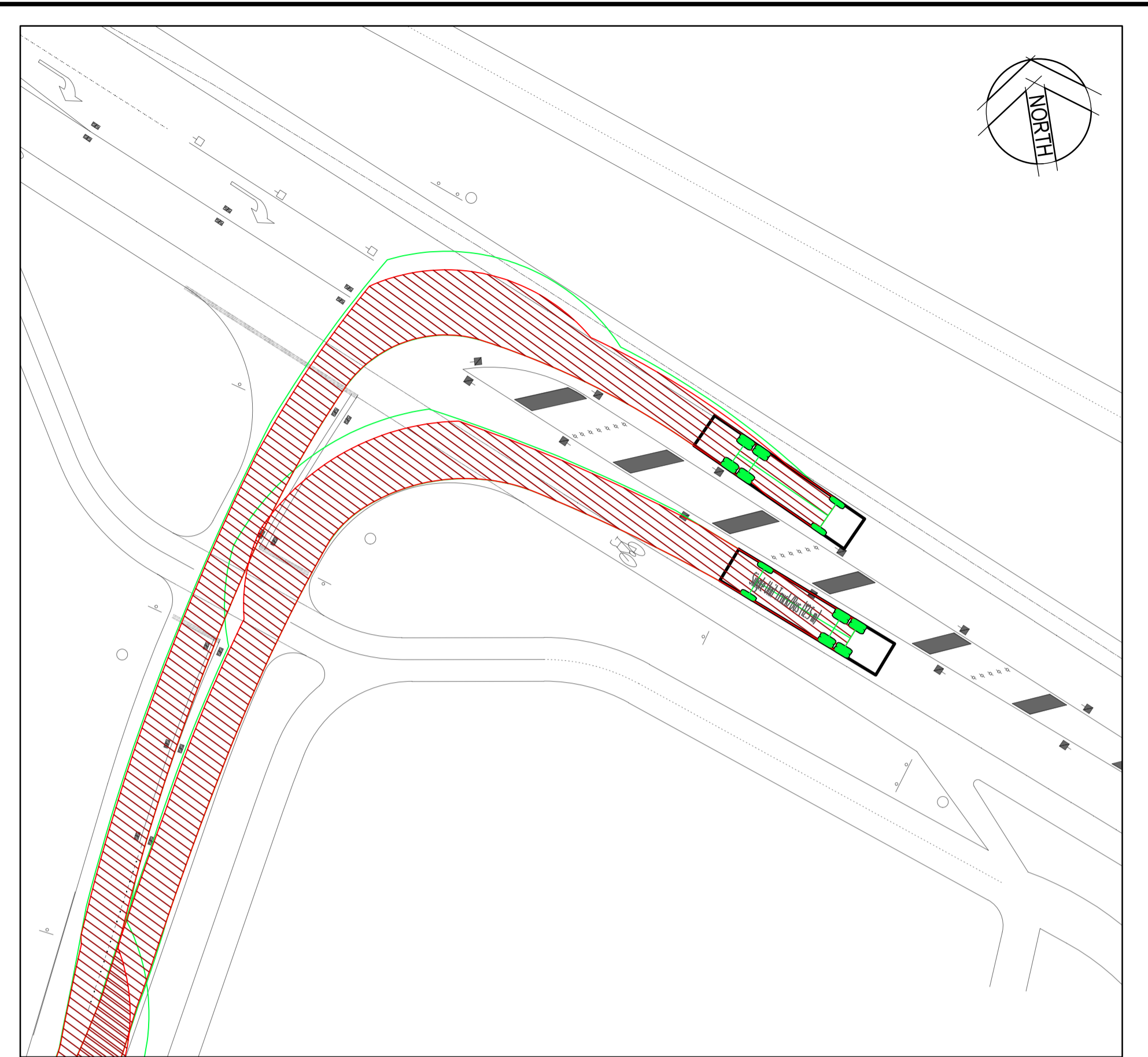

INSET 'C'  
1:300

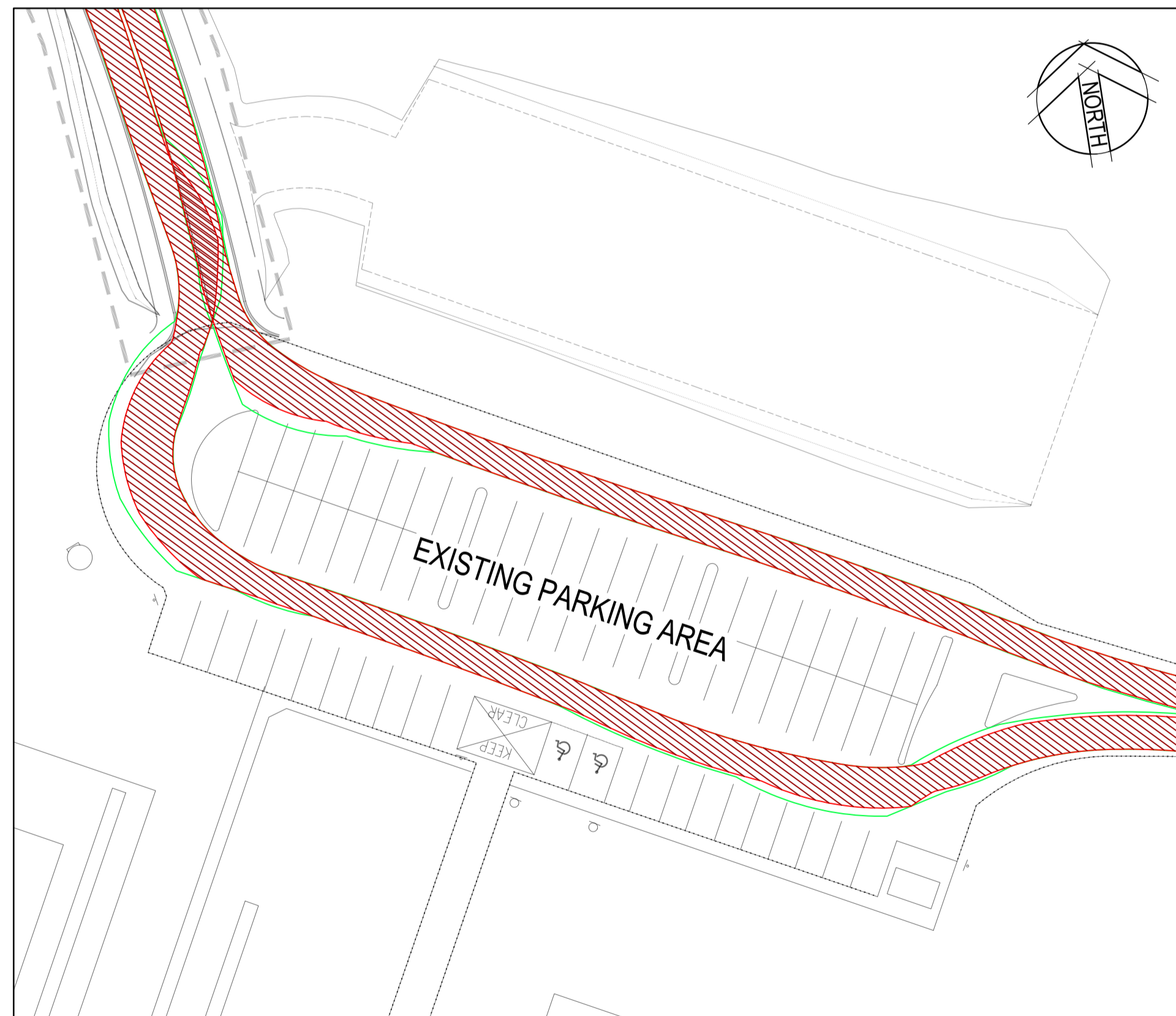

INSET 'A'  
1:400

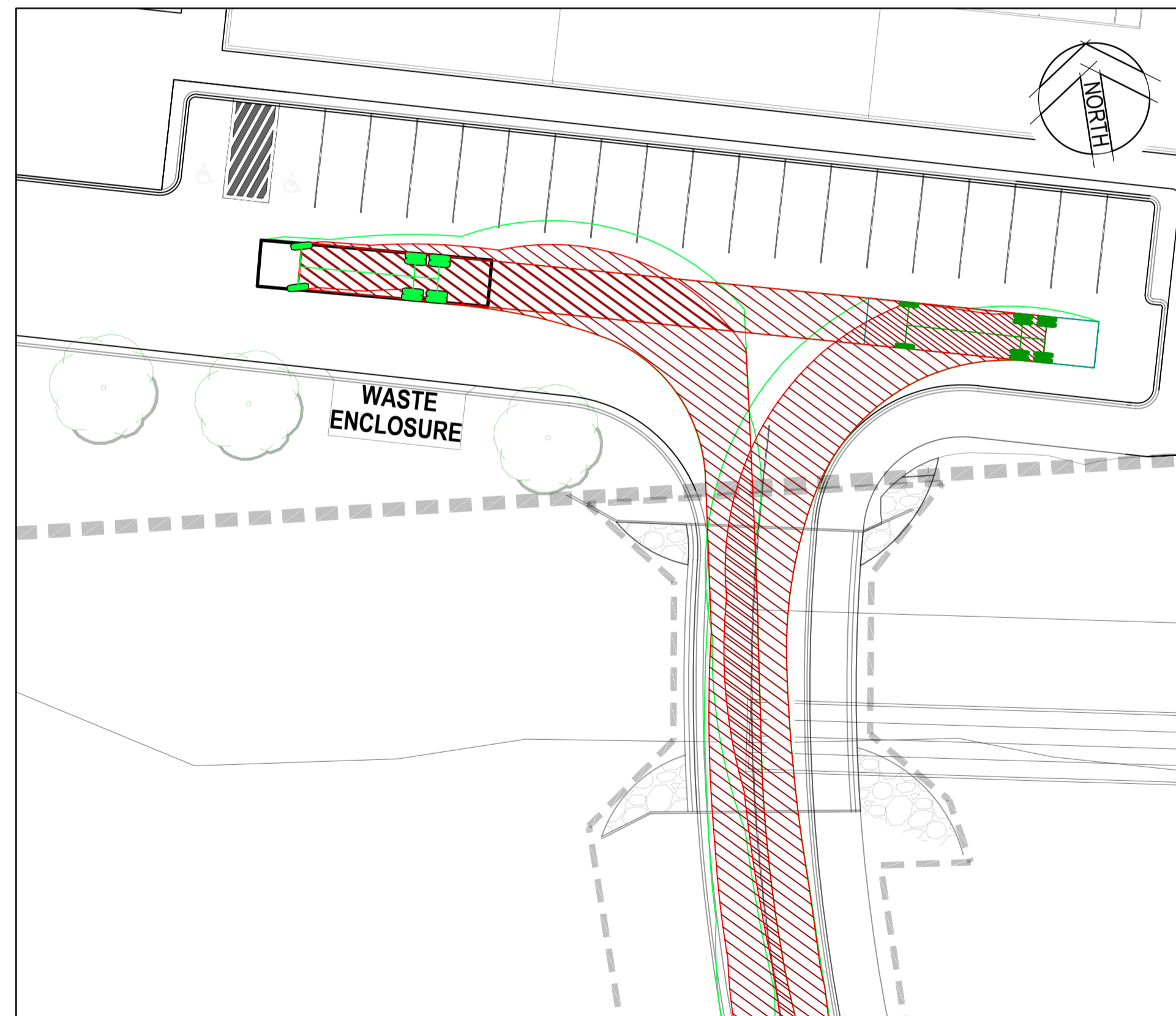

INSET 'B'  
1:250

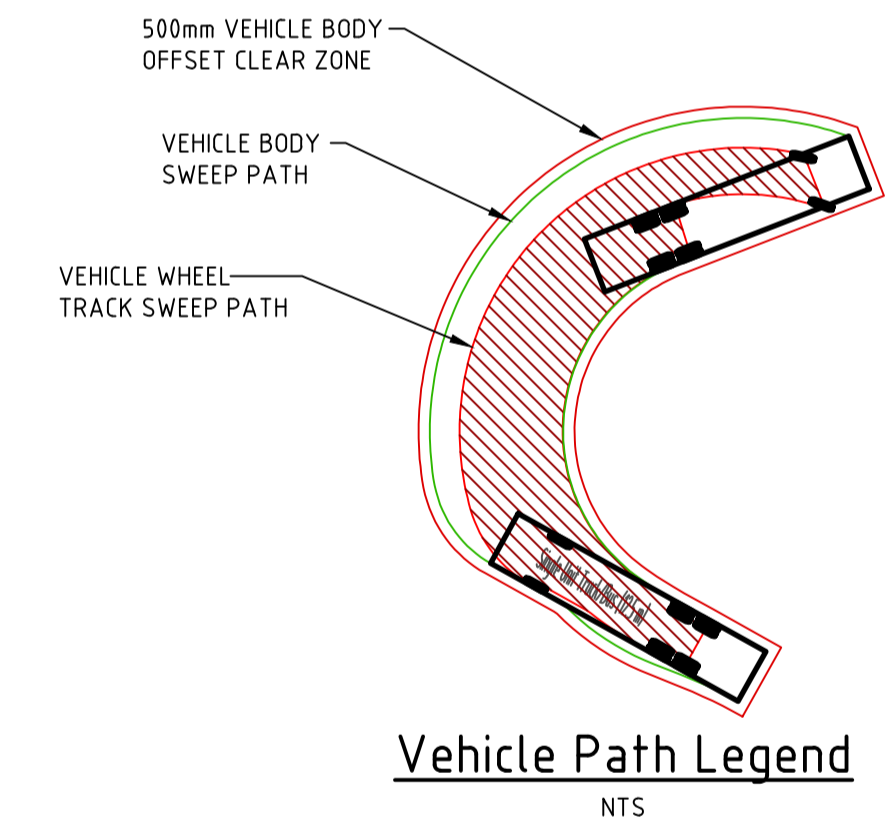

- NOTE:**
- DESIGN LAYOUT IS INDICATIVE ONLY AND SUBJECT TO CHANGE.
  - LANDSCAPE WORKS AND INTERNAL WORKS ARE PART OF A SEPARATE DA AND DO NOT FORM PART OF THIS APPROVAL APPLICATION.

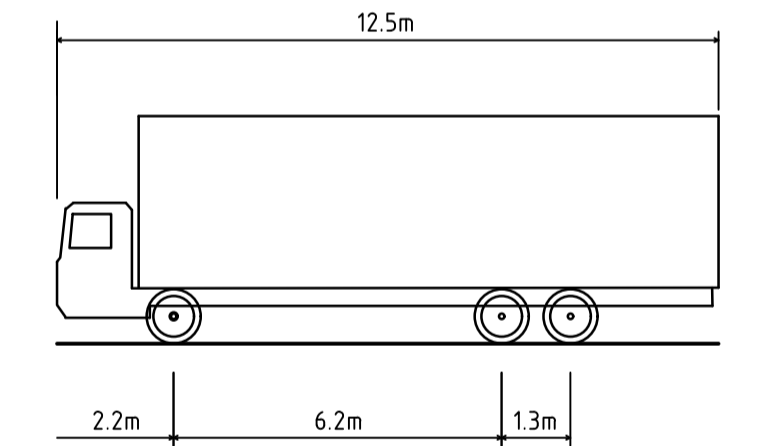

Austroads 2013 Design Vehicle  
Single Unit Truck/Bus (12.5 m)

Overall Length	12.500m
Overall Width	2.500m
Overall Body Height	4.300m
Min Body Ground Clearance	0.490m
Track Width	2.500m
Lock-to-lock time	6.00s
Curb to Curb Turning Radius	12.500m

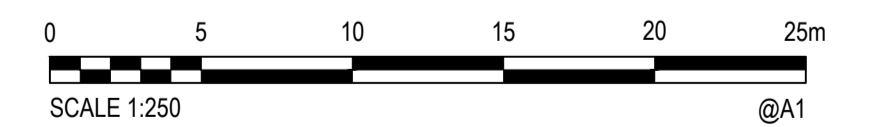

Rev.	Date	Description	Des.	Verif.	Appd.
C	21/11/2023	FOR APPROVAL	TM	GZ	JPS
B	13/11/2023	FOR APPROVAL	TM	GZ	JPS
A	23/05/2023	FINAL SKETCH PLAN	TM	GZ	JPS



© Stantec Limited All Rights Reserved.  
This document is produced by Stantec Limited solely for the benefit of and use by the client in accordance with the terms of the retainer. Stantec Limited does not and shall not assume any responsibility or liability whatsoever to any third party arising out of any use or reliance by third party on the content of this document.

Stantec Australia Pty Ltd | ABN 17 007 820 322  
Eastern Core, Level 4, 2 Constitution Ave  
Canberra, ACT 2601  
Tel: 02 6112 4500  
Web: www.stantec.com/au

Drawn	Date	Client
NH	23/05/2023	Chief Minister, Treasury and Economic Development Directorate
Checked	Date	Project
AS	23/05/2023	NEW GUNGAHLIN TENNIS FACILITY DEVELOPMENT APPLICATION (AMAROO, BLOCK 4, SECTION 109 - NORTHERN SIDE)
Designed	Date	Title
TM	23/05/2023	WASTE COLLECTION PLAN
Verified	Date	
GZ	23/05/2023	
Approved	Date	
JPS	23/05/2023	

Page No.	Datum	Scale	Size
11.01	AHD	AS SHOWN	A1
Drawing Number		Revision	
304000930-WCP-1040		C	

Status			
<b>FOR APPROVAL</b>			
NOT TO BE USED FOR CONSTRUCTION PURPOSES			