

AREA ANALYSIS:	
BLOCK 6	
SITE AREA	2853m²
PROPOSED BUILDING 1 AREA	352.00m²
GFA	352.00m²
BLOCK 7	
SITE AREA	4981m²
PROPOSED BUILDING 3 AREA	
TENANCY 1	80.00m²
TENANCY 2	80.00m²
TENANCY 3	80.00m²
PROPOSED BUILDING 2 AREA	255.00m²
EXISTING SERVICE STATION AREA	230.00m²
GFA	725.00m²

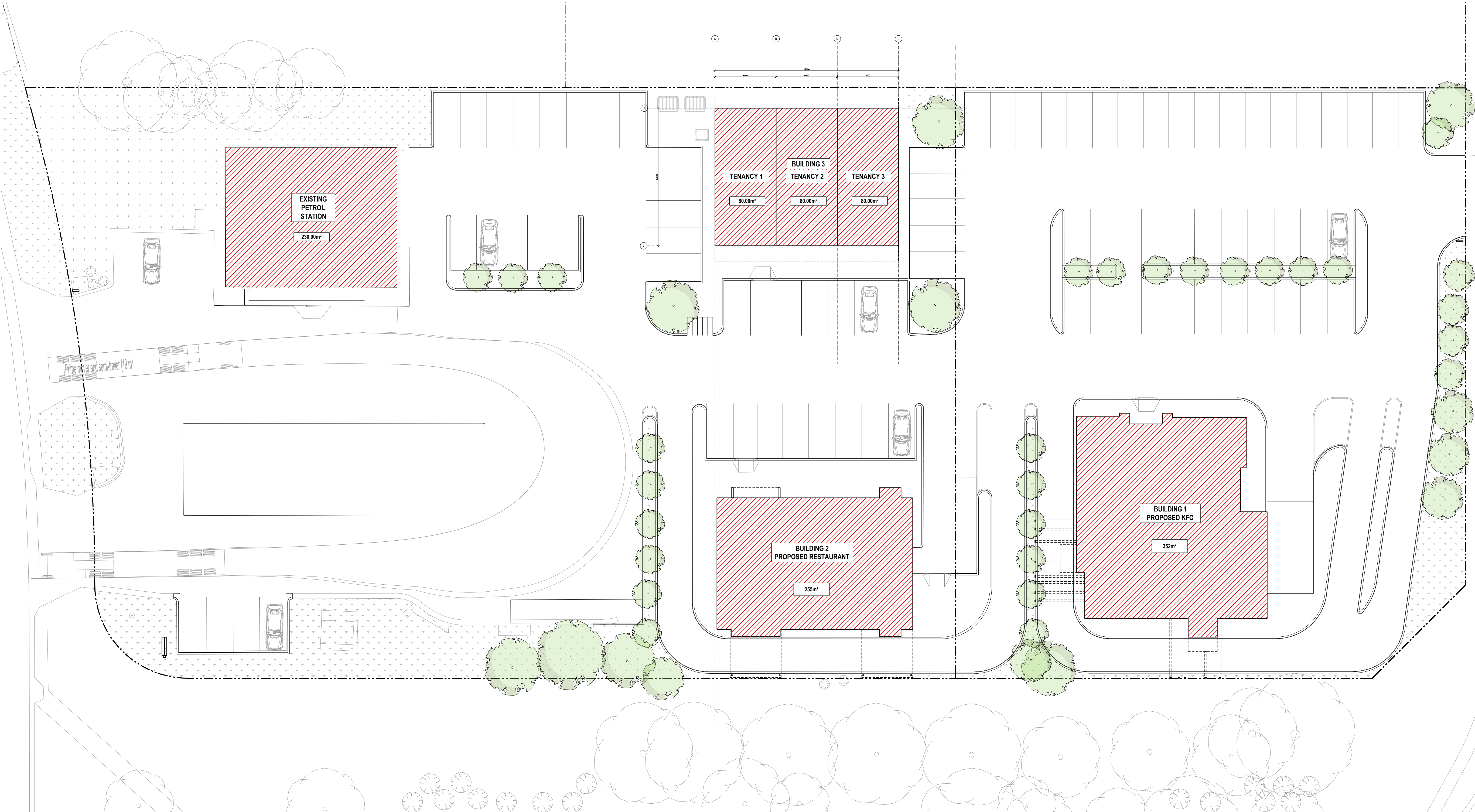

SUITE 10, 14 LONSDALE ST
BRADSDON A.C.T 2612
ABN: 17 600 270 522
T: 02 6226 4660
www.dna.com.au
Principal Noriwee Glen Downe
Registration 968

GENERAL NOTES:

ALL WORKS ARE TO COMPLY WITH THE RELEVANT AUSTRALIAN STANDARDS & ALL RELEVANT AUTHORITY REQUIREMENTS.

ALL DIMENSIONS DEPENDENT ON EXISTING SITE CONDITIONS SHALL BE VERIFIED BY THE BUILDER ON SITE PRIOR TO THE COMMENCEMENT OF THE WORKS. DO NOT SCALE OFF DRAWING.

A REGISTERED SURVEYOR TO SET OUT STRUCTURE & CONFIRM POSITIONS OF ALL RELEVANT BUILDING ENVELOPE SETBACKS & EASEMENTS PRIOR TO THE COMMENCEMENT OF THE WORKS.

ALL TIMBER FRAMING & CONSTRUCTION MUST COMPLY WITH AS1684 THE NATIONAL TIMBER FRAMING CODE. PROVIDE TEMPORARY & PERMANENT BRACING TO ALL FRAMING IN ACCORDANCE WITH THE STANDARD.

ALL CONCRETE SLABS & FOOTINGS ARE SUBJECT TO A SOIL CLASSIFICATION & ARE TO COMPLY WITH ENGINEERS DRAWINGS OR AS870 RESIDENTIAL SLABS & FOOTINGS CODE INCLUDING ALL RELEVANT REGION SPECIFIC SUPPLEMENTS.

ALL STORM WATER DRAINAGE & SEWERAGE TO BE CONNECTED TO EXISTING SERVICES IN ACCORDANCE WITH THE NCC & ALL LOCAL AUTHORITY REQUIREMENTS OR SELECTED RAINWATER TANK OR SEPTIC SYSTEM.

ALL UTILITIES, BEAMS & SUPPORTS TO BE SPECIFIED BY A REGISTERED ENGINEER OR RELEVANT AUSTRALIAN STANDARD.

PROVIDE TERMITE CONTROL TO SUB-FLOOR IN ACCORDANCE WITH THE NCC & ALL RELEVANT LOCAL AUTHORITY REQUIREMENTS OR PROVIDE ANY CAPPING AND TERMITE BARRIER.

THE STRUCTURE SHALL BE MAINTAINED IN A STABLE CONDITION AT ALL TIMES, & NO ELEMENT SHALL BE OVERSTRESSED, DURING & AFTER CONSTRUCTION.

ALL WET AREA FIXTURES SHALL BE TO CLIENT'S SELECTION OR INCLUSIONS LIST AND SATISFY THE APPROPRIATE WELL RATING.

ALL WINDOWS TO BE CERTIFIED TO MEET THE REQUIRED ENERGY RATING SPECIFICATION AND BE INSTALLED WITH FLASHINGS TO PREVENT WATER INGRESS.

COPYRIGHT:

© COPYRIGHT DOWSE NORWOOD ASSOCIATES ARCHITECTS PTY LTD.

THIS ARCHITECTURAL DESIGN AND ACCOMPANYING DOCUMENTATION, INCLUDING BUT NOT LIMITED TO PLANS, DRAWINGS, AND SPECIFICATIONS, ARE PROTECTED UNDER COPYRIGHT LAWS AND INTERNATIONAL TREATIES. UNAUTHORIZED REPRODUCTION, DISTRIBUTION, OR USE OF THIS DESIGN, IN WHOLE OR IN PART, IS STRICTLY PROHIBITED.

AMENDMENTS

REV. A	01.09.2023
--------	------------

1. DA DOCUMENTATION

DA DOCUMENTATION

NOT FOR CONSTRUCTION

DRAWING

AREA PLAN

PROJECT 149 CANBERRA AVENUE

SCALE 1:200 @ A1

PRINT DATE 01.09.2023

CLIENT	SPUNLOCK PTY LTD
BLOCK	06/07
SECTION	07
ADDRESS	149 CANBERRA AVENUE
SUBURB	FYSHWICK
STATE	ACT

NORTH

PROJECT NO.	21106
REVISION	A
REVISION DATE	01.09.2023
DRAWN	AB/SS

DWG NO. A103