

**CANOPY COVER - GROUND FLOOR**  
26% TOTAL SITE AREA (BLOCK 4)  
67% TOTAL OFF-SITE WORKS AREA (COMBINED UNLEASED LAND: BLOCK 5 / VERGE)

REFER TO L100 FOR CANOPY CONTRIBUTION CALCULATIONS

**CANOPY COVER - L6, L8, L11 & L12 ROOFTOPS**  
6% TOTAL SITE AREA (BLOCK 4)

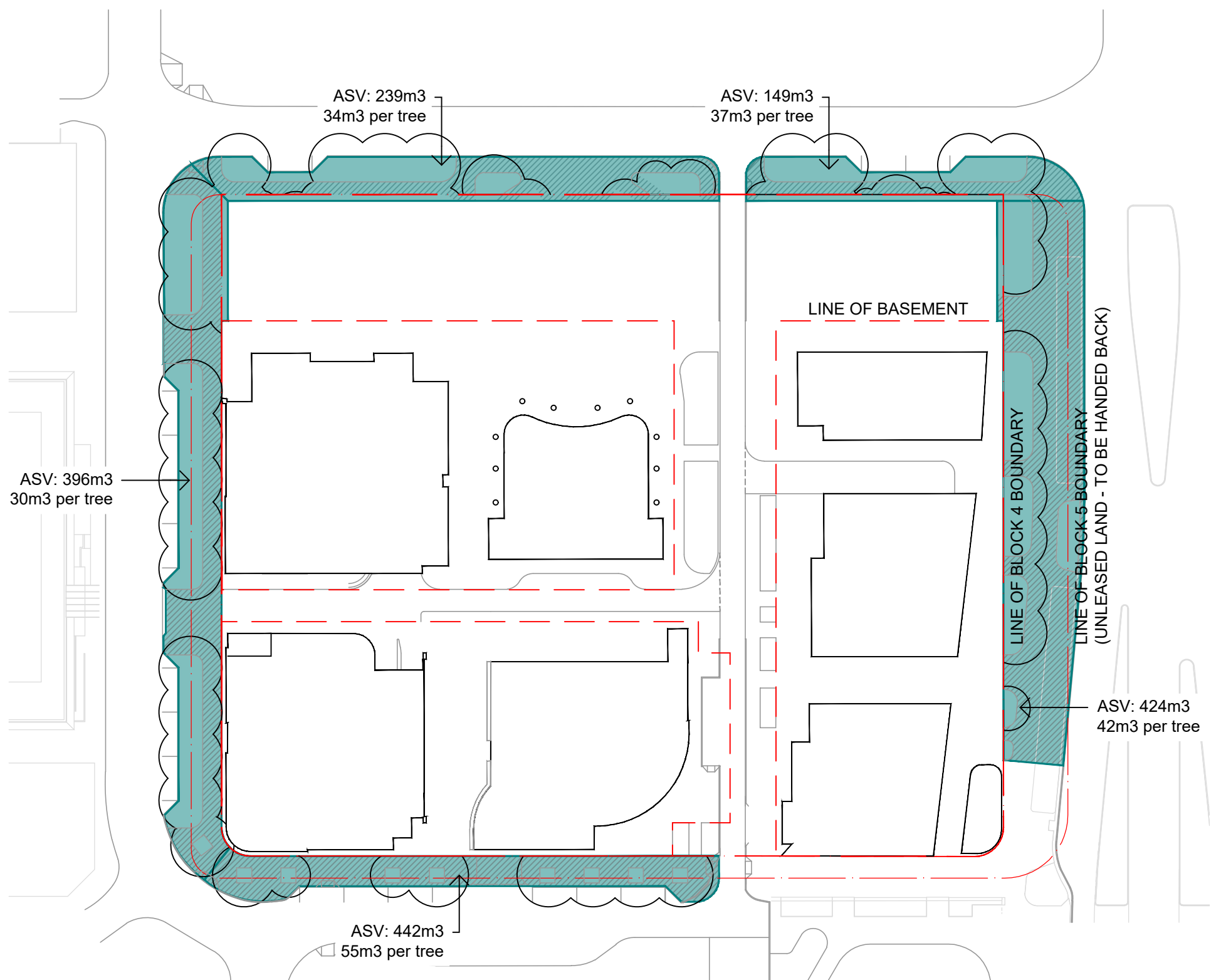

**AVAILABLE SOIL VOLUME**  
OFF-SITE WORKS (COMBINED UNLEASED LAND: BLOCK 5 / VERGE)  
CALCULATED USING THE MIS25 ASV CALCULATION METHOD: (ASV) = IZV - SZV

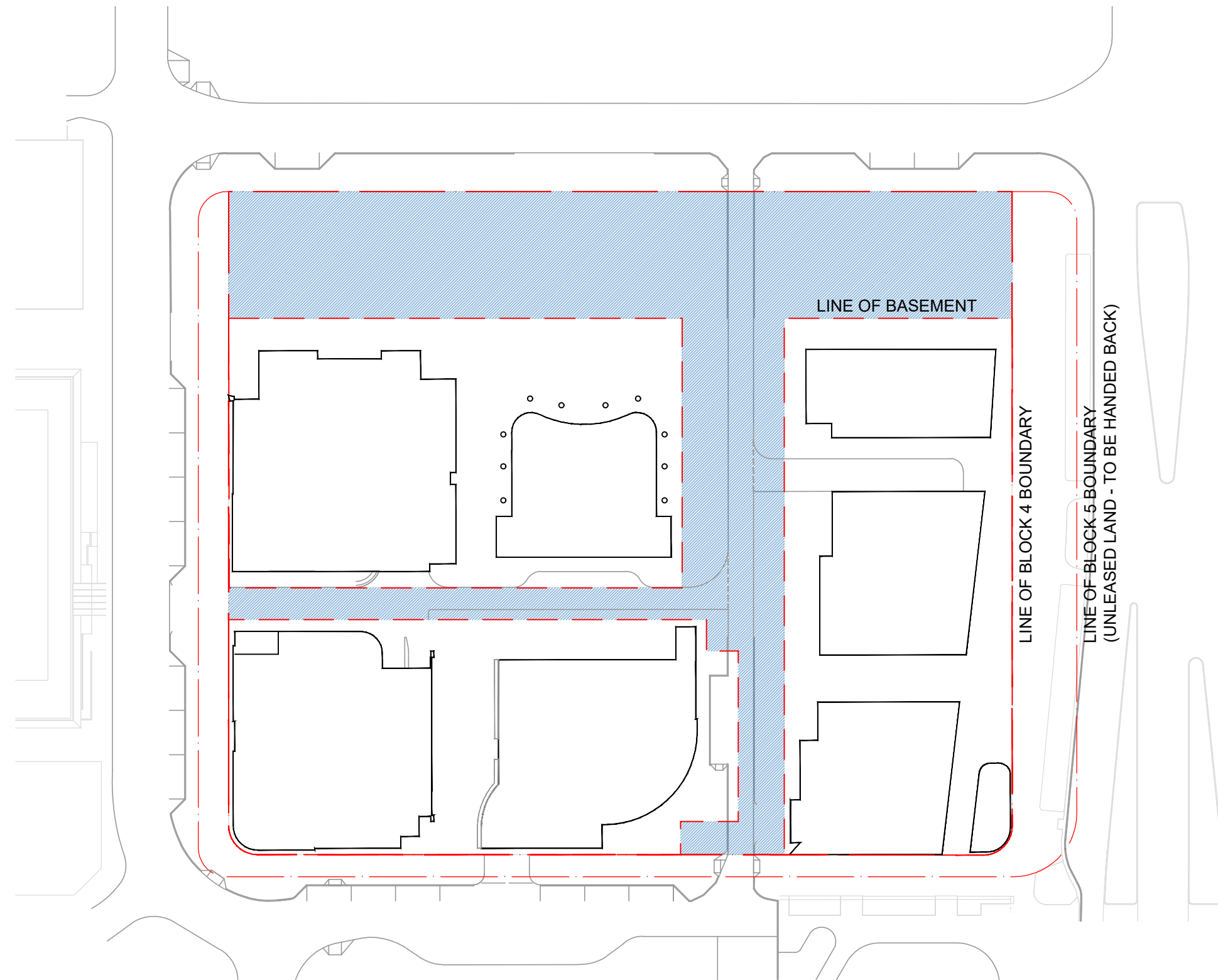

**SITE AREA FREE FROM BASEMENT**  
30% TOTAL SITE AREA (BLOCK 4)

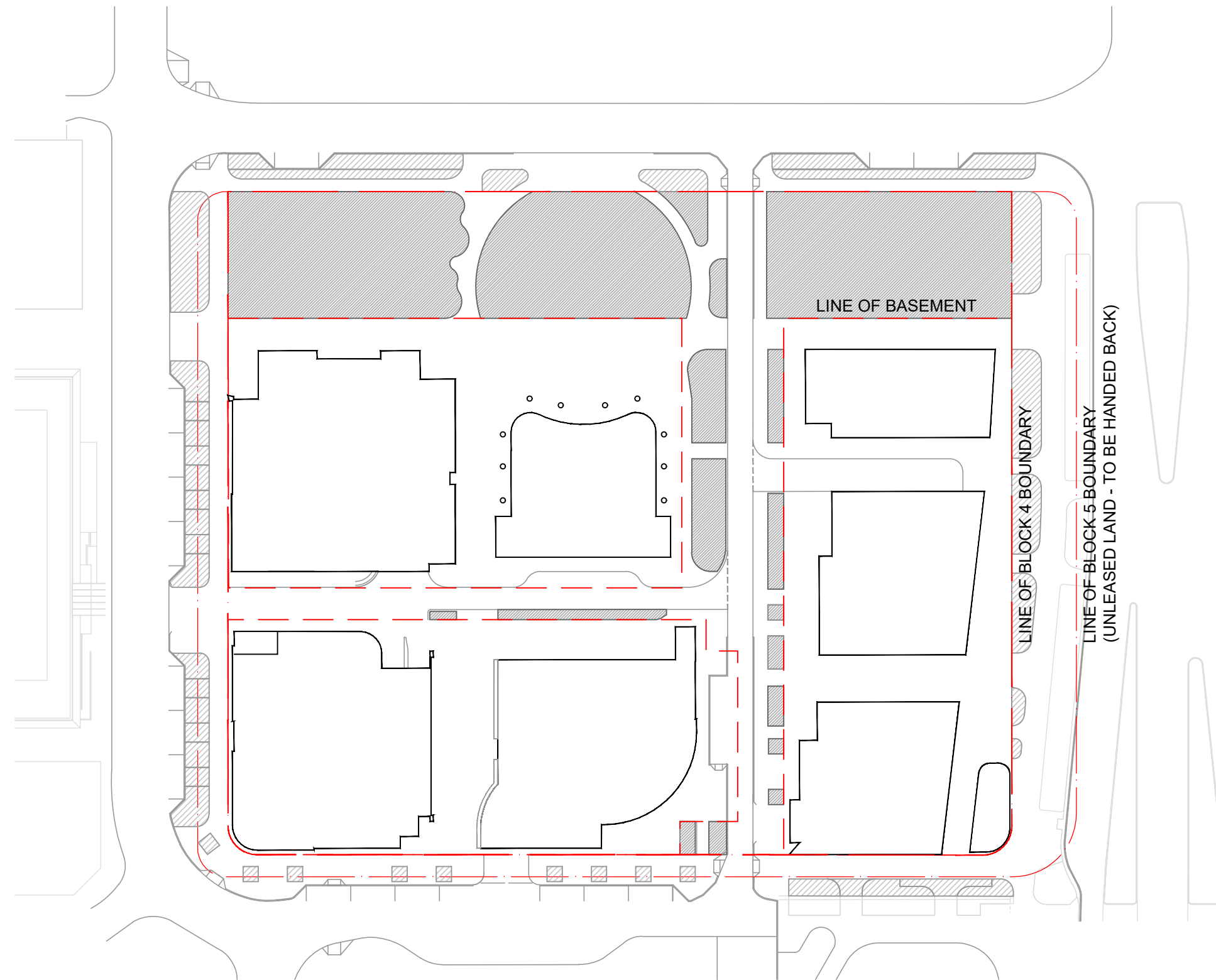

**PERMEABILITY & DEEP SOIL**  
20% TOTAL SITE AREA (BLOCK 4)  
29% TOTAL OFF-SITE WORKS AREA (COMBINED UNLEASED LAND: BLOCK 5 / VERGE)

**CALCULATION TOTALS:**

**CANOPY COVER**

| BLOCK 4                     | % TOTAL SITE |
|-----------------------------|--------------|
| EXISTING TOTAL:             | 0%           |
| EXISTING (NATIVE):          | 0%           |
| PROPOSED GF TOTAL:          | 26%          |
| PROPOSED GF (NATIVE):       | 13%          |
| PROPOSED ROOFTOPS TOTAL:    | 6%           |
| PROPOSED ROOFTOPS (NATIVE): | 1%           |

**TOTAL BLOCK 4 CANOPY COVER** >30%

| BLOCK 5 / VERGE    | % TOTAL VERGE |
|--------------------|---------------|
| EXISTING TOTAL:    | 35%           |
| EXISTING (NATIVE): | 3.7%          |
| PROPOSED TOTAL:    | 67%           |
| PROPOSED (NATIVE): | 17%           |

**PERMEABILITY**

| BLOCK 4   | % TOTAL SITE |
|-----------|--------------|
| EXISTING: | 0%           |
| PROPOSED: | 20%          |

| BLOCK 5 / VERGE | % TOTAL VERGE |
|-----------------|---------------|
| EXISTING:       | 16%           |
| PROPOSED:       | 29%           |

**DEEP SOIL**

| BLOCK 4                   | % TOTAL SITE |
|---------------------------|--------------|
| EXISTING:                 | 0%           |
| PROPOSED:                 | 20%          |
| AREA FREE FROM BASEMENTS: | 30%          |

- L1 QUANTITIES OF TREES UPDATED
- L2 PM14 REVISED TO SUIT NEW CONDITIONS
- L3 ROOFTOP LAYOUTS UPDATED
- L4 CHANGES TO ACCOMMODATE TRUCK TURNING CIRCLES
- L5 CANOPY COVER DIAGRAM AND CALCULATIONS UPDATED
- L6 DRIVEWAYS ADJUSTED TO REFLECT ENGINEER'S DOCUMENTATION
- L7 PLANTER LAYOUT ADJUSTED TO REFLECT ARCHITECTURAL CHANGES

This drawing is to be read in conjunction with all landscape architecture schedules, technical specifications, and other consultant drawings. Please check and verify all dimensions and site conditions prior to the commencement of any work. Do not scale drawings – refer to figured dimensions only. Please inform OCULUS of any discrepancies for clarification before proceeding. Unless otherwise noted this drawing is not for construction. Services shown on this drawing are approximate only, the exact location is to be confirmed on-site by contractor prior to commencement – before you dig (byda.com.au).  
© 2024

**KEY PLAN**

SCALE  
1:750 @ A1



PROJECT C-2307  
BLOCK 4 SECTION 7 PHILLIP

STATUS  
DEVELOPMENT APPLICATION

CLIENT  
HELLENIC PROPERTY INVESTMENTS

ARCHITECT  
METIER3

| ISSUE | DATE     | AMENDMENT    | BY  | APPROVED |
|-------|----------|--------------|-----|----------|
| A     | 30.06.25 | DRAFT        | JET | PM       |
| B     | 01.08.25 | FOR APPROVAL | RH  | JET      |
| C     | 12.08.25 | FOR APPROVAL | RH  | JET      |
| D     | 04.03.26 | FOR APPROVAL | RH  | PM       |

DRAWING TITLE  
**TREE CANOPY, PERMEABILITY & SOIL VOLUME DIAGRAMS**

DRAWING NUMBER  
**L008**

REVISION  
**D**